



Afrodita LED 220mm Double Emission

Leds C4 Team

05-9911-34-CL

Wall fixture IP65 Afrodita LED 220mm Double Emission LED 17.5W 3000K Grey 1494lm

TECHNICAL FEATURES



IP65 IK04

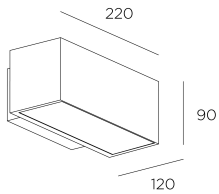

Power (W) : 17.5W

Total power consumption of light (W) : 17.9W

Real lumens : 1494

Real lm/W : 83

Colour temperature : LED warm-white 3000K

Lens / reflector angle : FLOOD 88°

Structure material : Aluminium

Structure finish : Grey

Diffuser material : Glass

Diffuser finish : Partly-sandblasted

Useful life : 50.000h L80B20

Equipment included : Yes, electronic

Voltage / frequency : 100-240V/50-60Hz

Warranty : 5 Years

Max. temperature : 25°C

Seaside : No

Energy efficiency : LED A++

LUMINOTECHNIC FEATURES

Light source: LED

CRI: 80

MacAdam steps: 3

Photobiological risk: RG0

LOGISTICS

Net weight (kg): 1.48

Packaged weight (kg): 1.57

Packaging: 230mm x 130mm x 100mm



4 Un

Luminaire

Code 05-9911-34-CL
 Name Aplique AFRODITA 17.5W 3000K

Measur.

Code 05-9911-34-CL
 Name Aplique AFRODITA 17.5W 3000K

Luminaire Flux	1494.40 lm	Luminaire Power	17.00 W	Efficacy	87.91 lm/W	Efficiency	100.00%
Lamps Flux	1494.40 lm	Maximum value	235.88 cd/klm	Position	C=0.00 G=0.00	CG	Asymmetrical
Rectangular Luminaire		Length	120 mm	Width	220 mm	Height	90 mm
Rectangular Luminous Area		Length	45 mm	Width	185 mm	Height	90 mm
Horizontal Luminous Area		0.008325 m2		Emitting area on Plane 180°		0.004050 m2	
Emitting area on Plane 0°		0.004050 m2		Emitting area on Plane 270°		0.016650 m2	
Emitting area on Plane 90°		0.016650 m2		Glare area at 76°		0.005944 m2	
Coordinate system		CG		Symmetry Type		Asymmetrical	
Date		04-04-2016		Maximum Gamma Angle		180	
Measurement Distance		0.00		Measurement Flux		1494.40 lm	
Operator		Asselum T2		Source Voltage [V]			
Temperature		25.00 °C		Source current [A]			
Humidity		60.00 %		Photocell			
Notes							

Line		Code		Luminaire Lamps		Flux [lm]	Pow. [W]	Q.ty
		05-9911-34-CL		05-9911-34-CL		1494.40	17.00	1
C.I.E.	58 86 97 50 100			D DIN 5040	C41			
F UTE	0.50 D + 0.50 T			B NBN	BZ 3			

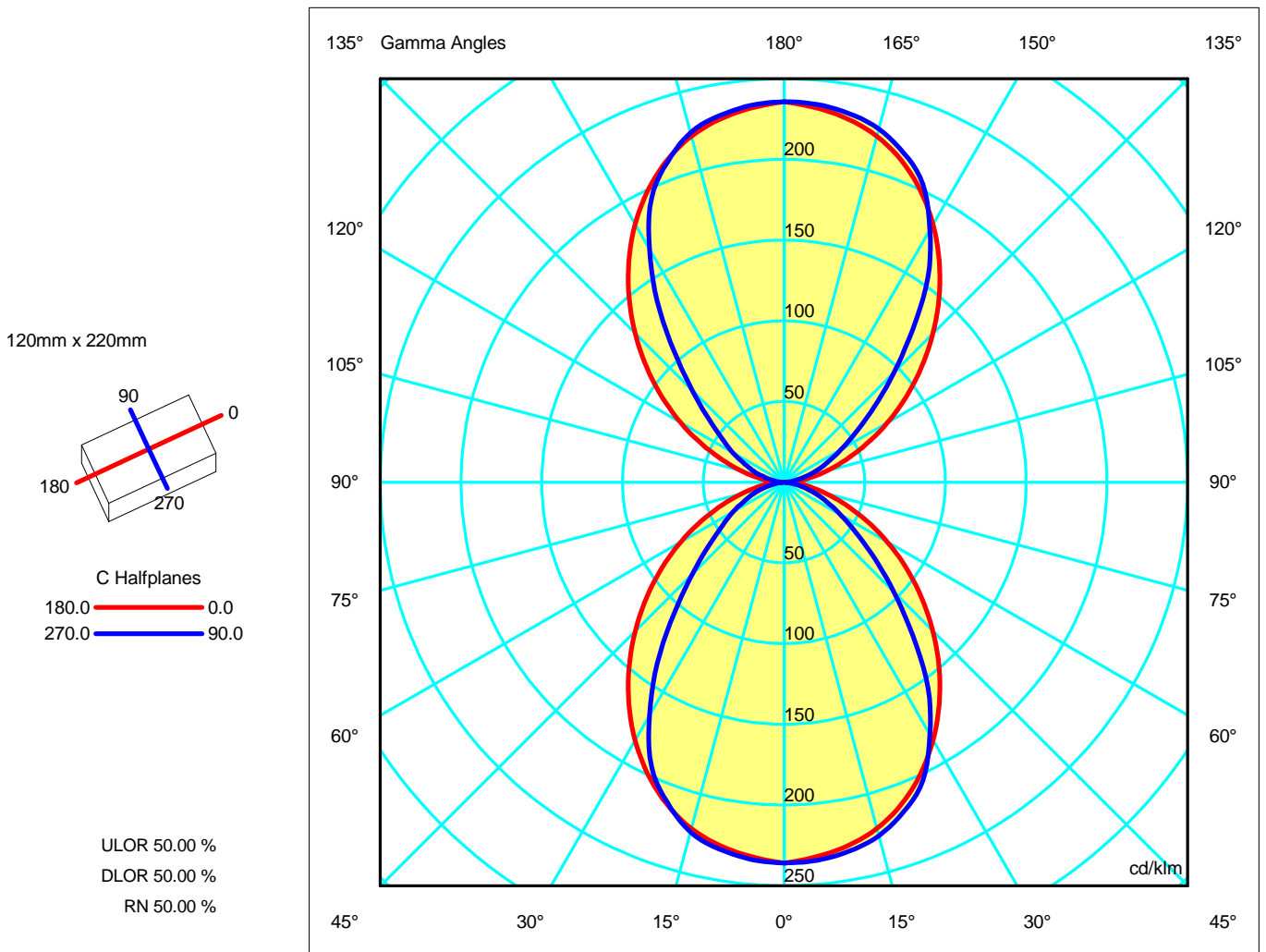

Luminaire

 Code 05-9911-34-CL
 Name Aplique AFRODITA 17.5W 3000K

Measuram.

 Code 05-9911-34-CL
 Name Aplique AFRODITA 17.5W 3000K

Luminaire Flux	1494.40 lm	Luminaire Power	17.00 W	Efficacy	87.91 lm/W	Efficiency	100.00%
Lamps Flux	1494.40 lm	Maximum value	235.88 cd/klm	Position	C=0.00 G=0.00	CG	Asymmetrical

Luminous Intensity Table cd/klm Table 1/1

	C 0.00	C 15.00	C 30.00	C 45.00	C 60.00	C 75.00	C 90.00	C 105.00	C 120.00	C 135.00	C 150.00	C 165.00
G 0.0	235.88	235.88	235.88	235.88	235.88	235.88	235.88	235.88	235.88	235.88	235.88	235.88
G 5.0	232.79	232.69	232.82	233.17	233.68	234.32	235.05	234.32	233.68	233.17	232.82	232.69
G 10.0	228.55	228.45	228.99	229.18	229.80	230.75	232.05	230.75	229.80	229.18	228.99	228.45
G 15.0	222.00	222.13	222.69	223.53	223.89	224.90	226.69	224.90	223.89	223.53	222.69	222.13
G 20.0	212.27	212.83	214.14	215.11	214.96	215.16	217.01	215.16	214.96	215.11	214.14	212.83
G 25.0	199.60	200.30	202.03	202.97	202.42	201.58	203.63	201.58	202.42	202.97	202.03	200.30
G 30.0	184.52	185.44	187.76	187.65	185.72	181.09	180.65	181.09	185.72	187.65	187.76	185.44
G 35.0	167.57	168.71	170.26	168.81	163.58	156.03	155.53	156.03	163.58	168.81	170.26	168.71
G 40.0	149.32	150.64	151.01	146.63	137.25	127.52	124.05	127.52	137.25	146.63	151.01	150.64
G 45.0	130.35	131.57	130.66	122.94	110.26	100.21	96.26	100.21	110.26	122.94	130.66	131.57
G 50.0	111.21	112.12	109.86	99.41	85.51	76.61	73.04	76.61	85.51	99.41	109.86	112.12
G 55.0	92.26	92.86	89.77	78.26	65.18	57.57	54.48	57.57	65.18	78.26	89.77	92.86
G 60.0	73.85	74.16	70.34	59.24	48.77	43.19	40.77	43.19	48.77	59.24	70.34	74.16
G 65.0	56.37	56.43	52.38	43.43	35.92	31.79	29.99	31.79	35.92	43.43	52.38	56.43
G 70.0	40.56	40.39	36.76	30.56	25.37	22.24	21.60	22.24	25.37	30.56	36.76	40.39
G 75.0	27.22	26.86	23.89	19.36	16.45	14.89	13.46	14.89	16.45	19.36	23.89	26.86
G 80.0	16.84	16.43	14.24	10.76	8.89	8.19	7.37	8.19	8.89	10.76	14.24	16.43
G 85.0	8.65	8.38	7.20	5.24	3.95	3.18	1.87	3.18	3.95	5.24	7.20	8.38
G 90.0	1.55	1.51	1.47	1.43	1.41	1.38	0.48	1.38	1.41	1.43	1.47	1.51
G 95.0	8.65	8.38	7.20	5.24	3.95	3.18	1.87	3.18	3.95	5.24	7.20	8.38
G100.0	16.84	16.43	14.24	10.76	8.89	8.19	7.37	8.19	8.89	10.76	14.24	16.43
G105.0	27.22	26.86	23.89	19.36	16.45	14.89	13.46	14.89	16.45	19.36	23.89	26.86
G110.0	40.56	40.39	36.76	30.56	25.37	22.24	21.60	22.24	25.37	30.56	36.76	40.39
G115.0	56.37	56.43	52.38	43.43	35.92	31.79	29.99	31.79	35.92	43.43	52.38	56.43
G120.0	73.85	74.16	70.34	59.24	48.77	43.19	40.77	43.19	48.77	59.24	70.34	74.16
G125.0	92.26	92.86	89.77	78.26	65.18	57.57	54.48	57.57	65.18	78.26	89.77	92.86
G130.0	111.21	112.12	109.86	99.41	85.51	76.61	73.04	76.61	85.51	99.41	109.86	112.12
G135.0	130.35	131.57	130.66	122.94	110.26	100.21	96.26	100.21	110.26	122.94	130.66	131.57
G140.0	149.32	150.64	151.01	146.63	137.25	127.52	124.05	127.52	137.25	146.63	151.01	150.64
G145.0	167.57	168.71	170.26	168.81	163.58	156.03	155.53	156.03	163.58	168.81	170.26	168.71
G150.0	184.52	185.44	187.76	187.65	185.72	181.09	180.65	181.09	185.72	187.65	187.76	185.44
G155.0	199.60	200.30	202.03	202.97	202.42	201.58	203.63	201.58	202.42	202.97	202.03	200.30
G160.0	212.27	212.83	214.14	215.11	214.96	215.16	217.01	215.16	214.96	215.11	214.14	212.83
G165.0	222.00	222.13	222.69	223.53	223.89	224.90	226.69	224.90	223.89	223.53	222.69	222.13
G170.0	228.55	228.45	228.99	229.18	229.80	230.75	232.05	230.75	228.99	229.18	228.99	228.45
G175.0	232.79	232.69	232.82	233.17	233.68	234.32	235.05	234.32	233.68	233.17	232.82	232.69
G180.0	235.88	235.88	235.88	235.88	235.88	235.88	235.88	235.88	235.88	235.88	235.88	235.88

	C 180.00	C 195.00	C 210.00	C 225.00	C 240.00	C 255.00	C 270.00	C 285.00	C 300.00	C 315.00	C 330.00	C 345.00
G 0.0	235.88	235.88	235.88	235.88	235.88	235.88	235.88	235.88	235.88	235.88	235.88	235.88
G 5.0	232.79	232.55	232.56	232.79	233.22	233.80	234.51	233.80	233.22	232.79	232.56	232.55
G 10.0	228.55	228.19	228.48	228.30	228.64	229.44	230.70	229.44	228.64	228.30	228.48	228.19
G 15.0	222.00	221.76	221.74	221.96	221.73	222.47	224.29	222.47	221.73	221.96	221.74	221.76
G 20.0	212.27	212.36	212.72	212.48	211.07	210.08	211.24	210.08	211.07	212.48	212.72	212.36
G 25.0	199.60	199.61	199.84	198.97	196.18	193.21	194.28	193.21	196.18	198.97	199.84	199.61
G 30.0	184.52	184.49	184.74	182.06	176.12	167.59	166.72	167.59	176.12	182.06	184.74	184.49
G 35.0	167.57	167.47	166.34	160.80	149.03	139.04	136.90	139.04	149.03	160.80	166.34	167.47
G 40.0	149.32	149.08	146.11	136.06	121.61	110.09	106.05	110.09	121.61	136.06	146.11	149.08
G 45.0	130.35	129.72	124.74	110.69	95.79	84.46	80.25	84.46	95.79	110.69	124.74	129.72
G 50.0	111.21	110.12	103.39	88.08	73.53	64.27	60.78	64.27	73.53	88.08	103.39	110.12
G 55.0	92.26	90.88	83.60	68.64	55.52	49.06	46.47	49.06	55.52	68.64	83.60	90.88
G 60.0	73.85	72.36	65.14	52.29	42.58	37.43	36.47	37.43	42.58	52.29	65.14	72.36
G 65.0	56.37	54.97	48.42	38.51	31.87	28.35	26.75	28.35	31.87	38.51	48.42	54.97
G 70.0	40.56	39.33	33.97	27.24	22.81	20.37	19.91	20.37	22.81	27.24	33.97	39.33
G 75.0	27.22	26.20	22.14	17.62	15.13	13.82	12.51	13.82	15.13	17.62	22.14	26.20
G 80.0	16.84	16.08	13.28	10.17	8.46	7.95	7.05	7.95	8.46	10.17	13.28	16.08
G 85.0	8.65	8.25	6.84	5.19	4.00	3.41	2.51	3.41	4.00	5.19	6.84	8.25
G 90.0	1.55	1.57	1.57	1.59	1.59	1.63	0.57	1.63	1.59	1.59	1.57	1.57
G 95.0	8.65	8.25	6.84	5.19	4.00	3.41	2.51	3.41	4.00	5.19	6.84	8.25
G100.0	16.84	16.08	13.28	10.17	8.46	7.95	7.05	7.95	8.46	10.17	13.28	16.08
G105.0	27.22	26.20	22.14	17.62	15.13	13.82	12.51	13.82	15.13	17.62	22.14	26.20
G110.0	40.56	39.33	33.97	27.24	22.81	20.37	19.91	20.37	22.81	27.24	33.97	39.33
G115.0	56.37	54.97	48.42	38.51	31.87	28.35	26.75	28.35	31.87	38.51	48.42	54.97
G120.0	73.85	72.36	65.14	52.29	42.58	37.43	36.47	37.43	42.58	52.29	65.14	72.36
G125.0	92.26	90.88	83.60	68.64	55.52	49.06	46.47	49.06	55.52	68.64	83.60	90.88
G130.0	111.21	110.12	103.39	88.08	73.53	64.27	60.78	64.27	73.53	88.08	103.39	110.12
G135.0	130.35	129.72	124.74	110.69	95.79	84.46	80.25	84.46	95.79	110.69	124.74	129.72
G140.0	149.32	149.08	146.11	136.06	121.61	110.09	106.05	110.09	121.61	136.06	146.11	149.08
G145.0	167.57	167.47	166.34	160.80	149.03	139.04	136.90	139.04	149.03	160.80	166.34	167.47
G150.0	184.52	184.49	184.74	182.06	176.12	167.59	166.72	167.59	176.12	182.06	184.74	184.49
G155.0	199.60	199.61	199.84	198.97	196.18	193.21	194.28	193.21	196.18	198.97	199.84	199.61
G160.0	212.27	212.36	212.72	212.48	211.07	210.08	211.24	210.08	211.07	212.48	212.72	212.36
G165.0	222.00	221.76	221.74	221.96	221.73	222.47	224.29	222.47	221.73	221.96	221.74	221.76
G170.0	228.55	228.19	228.48	228.30	228.64	229.44	230.70	229.44	228.64	228.30	228.48	228.19
G175.0	232.79	232.55	232.56	232.79	233.22	233.80	234.51	233.80	233.22	232.79	232.56	232.55
G180.0	235.88	235.88	235.88	235.88	235.88	235.88	235.88	235.88	235.88	235.88	235.88	235.88

Luminaire

Code 05-9911-34-CL
 Name Applique AFRODITA 17.5W 3000K

Measur.

Code 05-9911-34-CL
 Name Applique AFRODITA 17.5W 3000K

Luminaire Flux	1494.40 lm	Luminaire Power	17.00 W	Efficacy	87.91 lm/W	Efficiency	100.00%
Lamps Flux	1494.40 lm	Maximum value	235.88 cd/klm	Position	C=0.00 G=0.00	CG	Asymmetrical

120mm x 220mm

C Halfplanes

180.0 ——— 0.0
 270.0 ——— 90.0

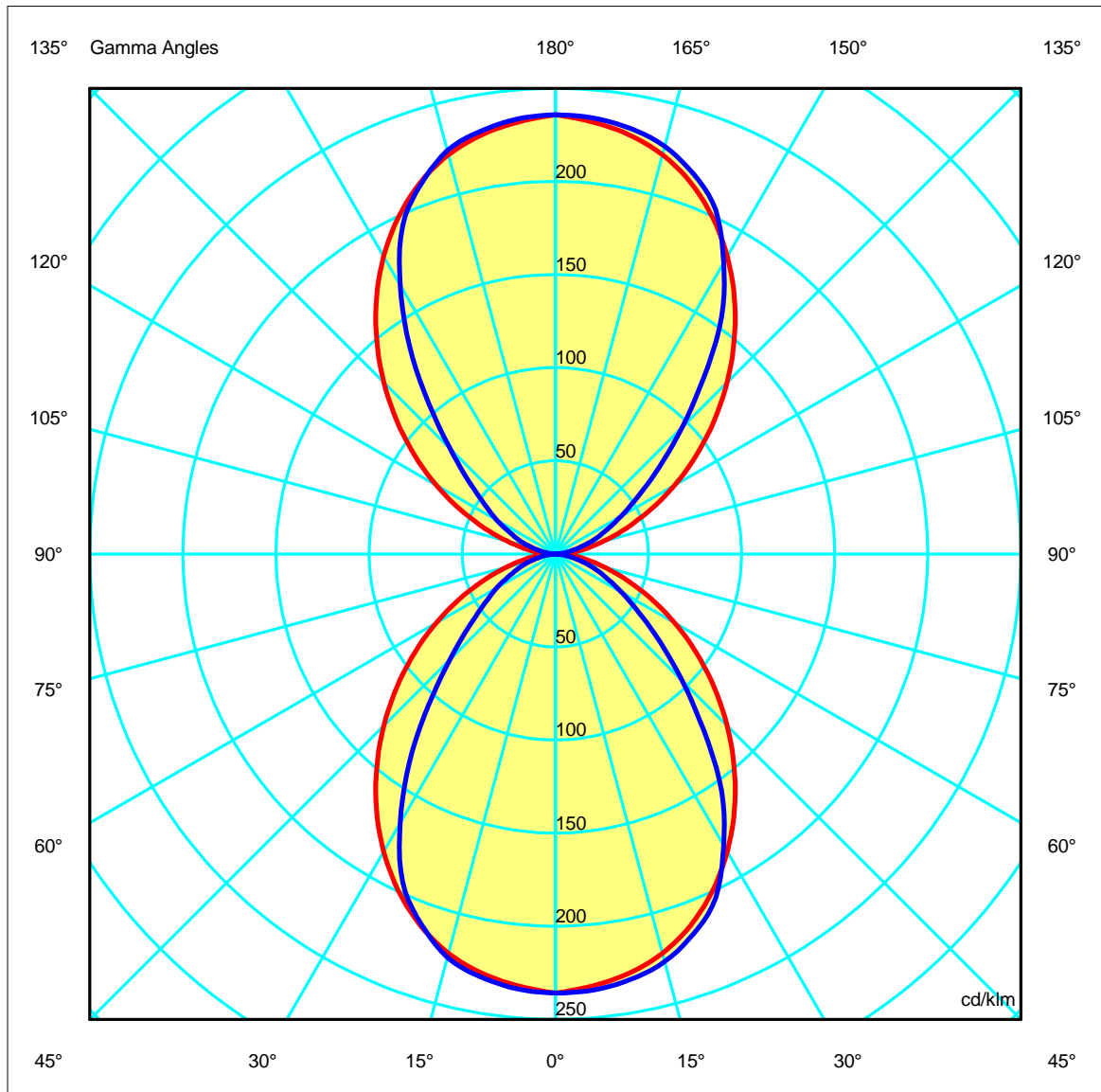
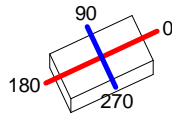

Luminaire

Code 05-9911-34-CL
 Name Aplique AFRODITA 17.5W 3000K

Measur.

Code 05-9911-34-CL
 Name Aplique AFRODITA 17.5W 3000K

Luminaire Flux	1494.40 lm	Luminaire Power	17.00 W	Efficacy	87.91 lm/W	Efficiency	100.00%
Lamps Flux	1494.40 lm	Maximum value	235.88 cd/klm	Position	C=0.00 G=0.00	CG	Asymmetrical

Width at 50.00 % of Max Intensity

H[m]	1.00	2.00	3.00	4.00	5.00	H[m]	1.00	2.00	3.00	4.00	5.00
OA	1.12	2.24	3.36	4.48	5.60	OC	0.87	1.74	2.61	3.48	4.35
OB	1.12	2.24	3.36	4.48	5.60	OD	0.78	1.56	2.35	3.13	3.91

	Luminous Intensities [cd/klm]									
	0	5	15	25	35	45	55	65	75	85
OA	352.50	347.88	331.75	298.28	250.42	194.80	137.88	84.24	40.68	12.93
OB	352.50	347.88	331.75	298.28	250.42	194.80	137.88	84.24	40.68	12.93
OC	352.50	351.26	338.76	304.31	232.42	143.85	81.41	44.82	20.11	2.79
OD	352.50	350.45	335.18	290.33	204.58	119.92	69.44	39.97	18.69	3.75

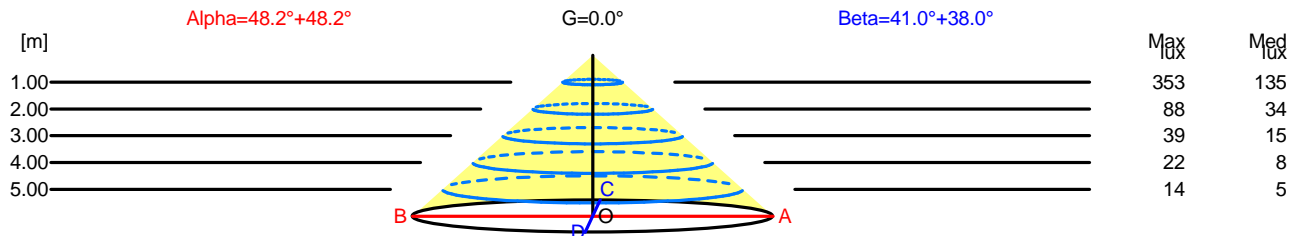

H[m]	D[m]	Max lux	Med lux	Alpha=48.2°+48.2°	G=0.0
1.00	2.24	353	135		
2.00	4.48	88	34		
3.00	6.72	39	15		
4.00	8.96	22	8		
5.00	11.20	14	5		

H[m]	D[m]	Max lux	Med lux	Beta=38.0°+41.0°	G=0.0
1.00	1.65	353	135		
2.00	3.30	88	34		
3.00	4.96	39	15		
4.00	6.61	22	8		
5.00	8.26	14	5		

Luminaire

Code 05-9911-34-CL
Name Aplique AFRODITA 17.5W 3000K

Measurement

Code 05-9911-34-CL
Name Aplique AFRODITA 17.5W 3000K

Luminaire Flux	1494.40 lm	Luminaire Power	17.00 W	Efficacy	87.91 lm/W	Efficiency	100.00%
Lamps Flux	1494.40 lm	Maximum value	235.88 cd/klm	Position	C=0.00 G=0.00	CG	Asymmetrical

UGR
S = 0.250

Reflectancies										
Ceiling/Cavity	0.7	0.7	0.5	0.5	0.3	0.7	0.7	0.5	0.5	0.3
Walls	0.5	0.3	0.5	0.3	0.3	0.5	0.3	0.5	0.3	0.3
WorkingPlane	0.2	0.2	0.2	0.2	0.2	0.2	0.2	0.2	0.2	0.2
RoomDimensions	ViewedCrosswise					ViewedEndwise				
x=2H y=2H	17.6	18.4	18.5	19.3	15.9	13.1	13.9	14.0	14.8	15.9
x=2H y=3H	18.5	19.2	19.4	20.1	16.2	13.5	14.1	14.4	15.0	16.2
x=2H y=4H	18.8	19.4	19.7	20.3	16.2	13.5	14.1	14.4	15.0	16.2
x=2H y=6H	19.0	19.5	19.9	20.5	16.2	13.5	14.0	14.4	15.0	16.2
x=2H y=8H	19.0	19.5	19.9	20.5	16.1	13.4	14.0	14.4	14.9	16.1
x=2H y=12H	19.0	19.5	19.9	20.4	16.1	13.4	13.9	14.3	14.8	16.1
x=4H y=2H	17.5	18.1	18.5	19.1	16.4	13.7	14.3	14.6	15.3	16.4
x=4H y=3H	18.5	19.0	19.5	20.0	16.8	14.1	14.6	15.1	15.6	16.8
x=4H y=4H	18.9	19.3	19.9	20.3	16.8	14.2	14.7	15.2	15.6	16.8
x=4H y=6H	19.1	19.5	20.1	20.5	16.9	14.2	14.6	15.2	15.6	16.9
x=4H y=8H	19.2	19.5	20.2	20.5	16.8	14.2	14.5	15.2	15.5	16.8
x=4H y=12H	19.2	19.5	20.2	20.5	16.7	14.1	14.4	15.1	15.4	16.7
x=8H y=4H	18.7	19.1	19.7	20.1	16.9	14.3	14.7	15.3	15.7	16.9
x=8H y=6H	19.0	19.3	20.0	20.3	17.0	14.4	14.6	15.4	15.7	17.0
x=8H y=8H	19.1	19.3	20.1	20.4	16.9	14.3	14.6	15.4	15.6	16.9
x=8H y=12H	19.1	19.4	20.2	20.4	16.9	14.3	14.5	15.3	15.5	16.9
x=12H y=4H	18.7	19.0	19.7	20.0	16.9	14.3	14.6	15.3	15.6	16.9
x=12H y=6H	18.9	19.2	20.0	20.2	16.9	14.3	14.6	15.4	15.6	16.9
x=12H y=8H	19.0	19.3	20.1	20.3	16.9	14.3	14.6	15.4	15.6	16.9

Luminaire

Code 05-9911-34-CL
 Name Aplique AFRODITA 17.5W 3000K

Measur.

Code 05-9911-34-CL
 Name Aplique AFRODITA 17.5W 3000K

Luminaire Flux	1494.40 lm	Luminaire Power	17.00 W	Efficacy	87.91 lm/W	Efficiency	100.00%
Lamps Flux	1494.40 lm	Maximum value	235.88 cd/klm	Position	C=0.00 G=0.00	CG	Asymmetrical

120mm x 220mm

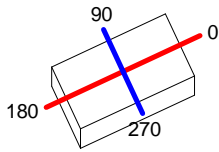

C Halfplanes

180.0 ———— 0.0
 270.0 ———— 90.0

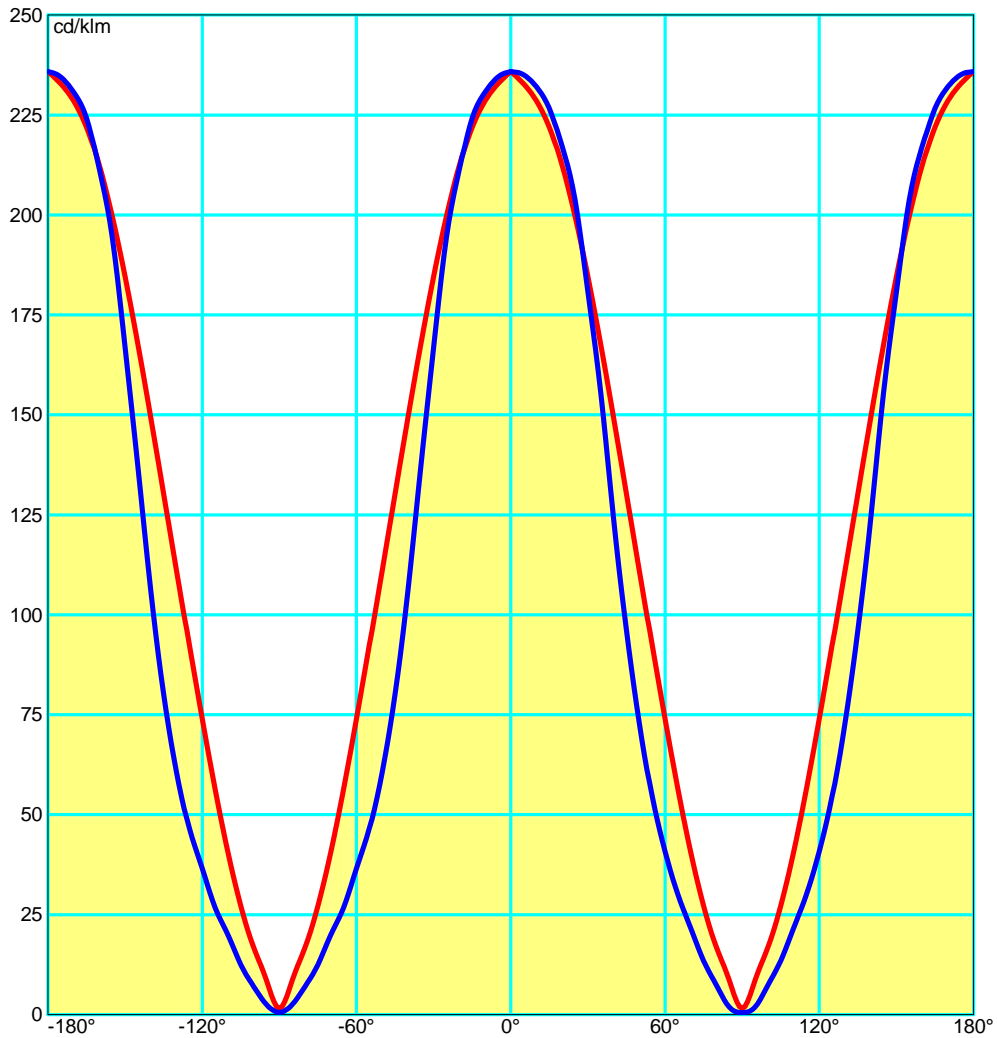

Luminaire

Code 05-9911-34-CL
 Name Aplique AFRODITA 17.5W 3000K

Measur.

Code 05-9911-34-CL
 Name Aplique AFRODITA 17.5W 3000K

Luminaire Flux	1494.40 lm	Luminaire Power	17.00 W	Efficacy	87.91 lm/W	Efficiency	100.00%
Lamps Flux	1494.40 lm	Maximum value	235.88 cd/klm	Position	C=0.00 G=0.00	CG	Asymmetrical

Luminance

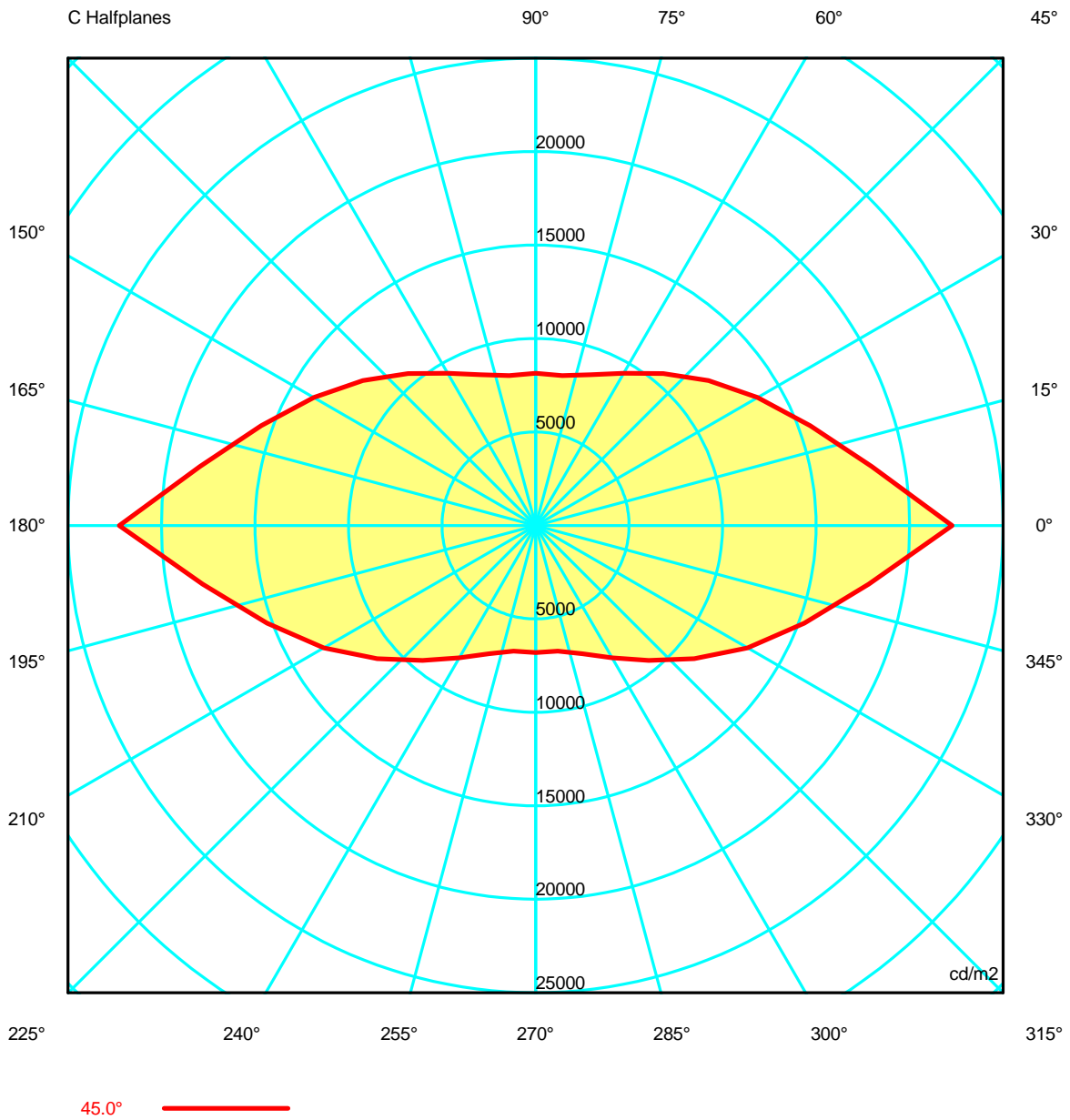

Luminaire

Code 05-9911-34-CL
Name Aplique AFRODITA 17.5W 3000K

Measurerm.

Code 05-9911-34-CL
Name Aplique AFRODITA 17.5W 3000K

Luminaire Flux	1494.40 lm	Luminaire Power	17.00 W	Efficacy	87.91 lm/W	Efficiency	100.00%
Lamps Flux	1494.40 lm	Maximum value	235.88 cd/klm	Position	C=0.00 G=0.00	CG	Asymmetrical

Luminance cd/m2 Table 1/3

	C 0.00	C 10.00	C 20.00	C 30.00	C 40.00	C 50.00	C 60.00	C 70.00	C 80.00	C 90.00	C 100.00	C 110.00	C 120.00
G 0.0	42342.36	42342.36	42342.36	42342.36	42342.36	42342.36	42342.36	42342.36	42342.36	42342.36	42342.36	42342.36	42342.36
G 5.0	40234.92	39104.48	38125.49	37313.16	36670.08	36200.94	35902.79	35773.32	35840.32	36047.46	35840.31	35773.34	35902.79
G 10.0	38367.80	36338.24	34689.46	33375.27	32313.53	31542.43	31066.52	30854.77	30952.58	31270.37	30952.56	30854.80	31066.52
G 15.0	36498.38	33784.93	31631.85	29971.19	28730.29	27818.76	27207.52	26932.86	27048.88	27428.57	27048.87	26932.87	27207.52
G 20.0	34449.12	31216.56	28777.00	26960.32	25600.61	24578.68	23888.76	23523.10	23597.53	23990.44	23597.53	23552.07	23888.76
G 25.0	32223.73	28587.81	25961.66	24065.23	22653.02	21610.95	20869.95	20426.31	20465.90	20869.30	20465.91	20426.30	20869.95
G 30.0	29860.55	25951.33	23270.00	21376.46	19898.66	18801.35	17984.76	17334.37	17121.20	17378.24	17121.20	17334.37	17984.76
G 35.0	27390.90	23352.80	20625.60	18699.99	17206.42	16021.67	15041.59	14235.66	14007.96	14198.51	13956.78	14235.63	15041.59
G 40.0	24847.16	20784.74	18081.03	16138.61	14573.13	13235.55	12102.77	11240.96	10801.70	10853.75	10801.71	11240.92	12102.77
G 45.0	22261.19	18240.57	15620.10	13699.36	12063.89	10611.09	9407.73	8584.76	8153.56	8145.47	8153.58	8584.72	9407.73
G 50.0	19658.54	15749.91	13255.27	11388.59	9729.47	8265.53	7119.33	6413.82	6054.26	6028.43	6054.27	6413.79	7119.33
G 55.0	17037.27	13324.28	11015.85	9272.67	7689.83	6337.34	5338.20	4751.74	4453.66	4421.07	4453.66	4751.73	5338.20
G 60.0	14388.06	10967.50	8880.54	7295.28	5872.43	4732.76	3960.01	3527.40	3305.98	3278.72	3305.99	3527.39	3960.01
G 65.0	11717.90	8685.25	6863.24	5496.67	4342.52	3474.98	2913.73	2593.26	2426.49	2408.34	2426.50	2593.25	2913.73
G 70.0	9110.22	6490.75	5026.98	3933.17	3086.37	2475.93	2071.89	1822.96	1723.29	1745.54	1723.30	1822.96	2071.89
G 75.0	6705.15	4581.61	3453.27	2628.71	2009.00	1596.54	1363.10	1238.06	1140.83	1102.92	1140.83	1238.06	1363.10
G 80.0	4631.98	3036.19	2204.19	1624.13	1178.70	893.91	753.43	692.09	641.12	617.07	641.11	692.10	753.43
G 85.0	2716.08	1682.42	1188.88	859.94	607.80	437.26	344.66	298.23	222.04	161.01	222.04	298.24	344.66
G 90.0	572.89	331.43	235.07	185.15	156.69	138.54	128.40	122.18	90.77	43.15	90.77	122.18	128.40

Luminaire

Code 05-9911-34-CL
Name Aplique AFRODITA 17.5W 3000K

Measuram.

Code 05-9911-34-CL
Name Aplique AFRODITA 17.5W 3000K

Luminaire Flux	1494.40 lm	Luminaire Power	17.00 W	Efficacy	87.91 lm/W	Efficiency	100.00%
Lamps Flux	1494.40 lm	Maximum value	235.88 cd/klm	Position	C=0.00 G=0.00	CG	Asymmetrical

Luminance cd/m2 Table 2/3

	C 130.00	C 140.00	C 150.00	C 160.00	C 170.00	C 180.00	C 190.00	C 200.00	C 210.00	C 220.00	C 230.00	C 240.00	C 250.00
G 0.0	42342.36	42342.36	42342.36	42342.36	42342.36	42342.36	42342.36	42342.36	42342.36	42342.36	42342.36	42342.36	42342.36
G 5.0	36200.83	36670.36	37313.16	38123.86	39108.71	40234.92	39093.45	38094.49	37271.05	36616.99	36137.81	35831.84	35696.34
G 10.0	31542.23	32314.04	33375.27	34686.46	36346.19	38367.80	36317.84	34635.78	33301.52	32207.61	31406.18	30910.02	30683.63
G 15.0	27818.71	28730.41	29971.19	31631.11	33786.94	36498.38	33752.59	31553.68	29843.22	28554.58	27596.30	26944.72	26646.73
G 20.0	24578.68	25600.43	26960.32	28778.08	31213.59	34449.12	31173.83	28678.69	26781.13	25337.32	24242.78	23456.68	23008.59
G 25.0	21611.00	22652.88	24065.23	25962.52	28585.40	32223.73	28529.55	25817.55	23803.92	22277.51	21109.19	20226.12	19641.68
G 30.0	18801.36	19898.62	21376.46	23270.28	25950.52	29860.55	25876.57	23062.59	21032.72	19409.33	18121.97	17054.91	16145.26
G 35.0	16021.80	17206.07	18699.99	20627.90	23346.18	27390.90	23249.00	20384.79	18269.88	16568.68	15042.57	13704.04	12755.31
G 40.0	13235.76	14572.57	16138.61	18084.83	20773.63	24847.16	20645.70	17797.14	15614.72	13734.18	12083.60	10723.28	9767.96
G 45.0	10611.28	12063.37	13699.36	15623.61	18230.19	22261.19	18077.23	15286.52	13077.83	11072.21	9414.30	8173.07	7302.15
G 50.0	8265.68	9729.06	11388.59	13258.13	15741.33	19658.54	15582.91	12878.79	10718.17	8784.02	7226.95	6122.63	5421.14
G 55.0	6337.43	7689.57	9272.67	11017.68	13318.70	17037.27	13160.91	10637.24	8635.19	6871.41	5479.10	4547.05	4043.37
G 60.0	4732.83	5872.23	7295.28	8881.95	10963.12	14388.06	10813.79	8536.72	6755.18	5249.92	4150.25	3457.49	3052.08
G 65.0	3475.04	4342.33	5496.67	6864.60	8680.98	11717.90	8551.11	6583.47	5080.23	3888.94	3069.63	2585.50	2310.51
G 70.0	2475.98	3086.25	3933.17	5027.86	6531.43	9110.22	6432.61	4820.93	3635.09	2771.63	2203.31	1862.75	1661.19
G 75.0	1596.53	2009.03	2628.71	3453.06	4617.59	6705.15	4554.91	3314.79	2435.38	1829.94	1455.55	1253.72	1147.28
G 80.0	893.87	1178.82	1624.13	2203.22	3039.41	4631.98	3006.34	2121.22	1515.22	1103.97	848.08	716.82	668.75
G 85.0	437.22	607.91	859.94	1188.05	1685.26	2716.08	1673.96	1153.79	816.36	590.64	439.15	349.06	308.38
G 90.0	138.54	156.70	185.15	235.00	331.69	572.89	339.79	246.60	198.55	171.12	154.45	144.64	154.74

Luminaire

Code 05-9911-34-CL
Name Aplique AFRODITA 17.5W 3000K

Measur.

Code 05-9911-34-CL
Name Aplique AFRODITA 17.5W 3000K

Luminaire Flux	1494.40 lm	Luminaire Power	17.00 W	Efficacy	87.91 lm/W	Efficiency	100.00%
Lamps Flux	1494.40 lm	Maximum value	235.88 cd/klm	Position	C=0.00 G=0.00	CG	Asymmetrical

Luminance cd/m2 Table 3/3

	C 260.00	C 270.00	C 280.00	C 290.00	C 300.00	C 310.00	C 320.00	C 330.00	C 340.00	C 350.00
G 0.0	42342.36	42342.36	42342.36	42342.36	42342.36	42342.36	42342.36	42342.36	42342.36	42342.36
G 5.0	35759.03	35964.17	35759.04	35696.32	35831.84	36137.92	36616.70	37271.05	38096.13	39089.21
G 10.0	30773.01	31087.54	30773.03	30683.60	30910.02	31406.37	32207.10	33301.52	34638.78	36309.89
G 15.0	26757.92	27138.67	26757.92	26646.72	26944.72	27596.35	28554.45	29843.22	31554.42	33750.57
G 20.0	23005.23	23352.66	23005.22	23008.60	23456.68	24242.71	25337.49	26781.13	28677.60	31176.81
G 25.0	19566.47	19910.76	19566.46	19641.69	20226.12	21109.14	22277.65	23803.92	25816.69	28537.70
G 30.0	15801.43	16037.75	15801.43	16145.26	17054.91	18121.95	19409.37	21032.72	23062.59	25877.37
G 35.0	12366.69	12497.70	12366.68	12755.33	13704.04	15042.44	16569.02	18269.88	20382.49	23255.63
G 40.0	9278.22	9278.72	9278.21	9768.00	10723.28	12083.39	13734.74	15614.72	17793.33	20640.50
G 45.0	6828.44	6790.59	6828.42	7302.19	8173.07	9414.11	11072.72	13077.83	15283.01	18087.61
G 50.0	5053.39	5016.21	5053.38	5421.17	6122.63	7226.80	8784.43	10718.17	12875.94	15591.48
G 55.0	3798.64	3771.28	3798.63	4043.38	4547.05	5479.01	6871.67	8635.19	10635.41	13166.49
G 60.0	2896.76	2932.70	2896.75	3052.09	3457.49	4150.18	5250.12	6755.18	8535.31	10818.17
G 65.0	2163.99	2147.98	2163.98	2310.52	2585.50	3069.57	3889.13	5080.23	6582.11	8555.38
G 70.0	1584.40	1608.80	1584.39	1661.20	1862.75	2203.27	2771.74	3635.09	4820.05	6435.43
G 75.0	1060.20	1024.84	1060.20	1147.28	1253.72	1455.56	1829.92	2435.38	3315.00	4554.24
G 80.0	620.49	590.59	620.49	668.74	716.82	848.12	1103.84	1515.22	2122.19	3003.12
G 85.0	255.89	216.59	255.89	308.38	349.06	439.19	590.53	816.36	1154.63	1671.12
G 90.0	107.95	51.47	107.95	142.05	144.64	154.45	171.12	198.55	246.28	339.53

Luminaire
 Code 05-9911-34-CL
 Name Aplique AFRODITA 17.5W 3000K
Measur.
 Code 05-9911-34-CL
 Name Aplique AFRODITA 17.5W 3000K

Luminaire Flux	1494.40 lm	Luminaire Power	17.00 W	Efficacy	87.91 lm/W	Efficiency	100.00%
Lamps Flux	1494.40 lm	Maximum value	235.88 cd/klm	Position	C=0.00 G=0.00	CG	Asymmetrical

PERCENTAGE ISOCANDLES

Projection: Equal Area SLI 7.4 Tight Tilting Angle:0°

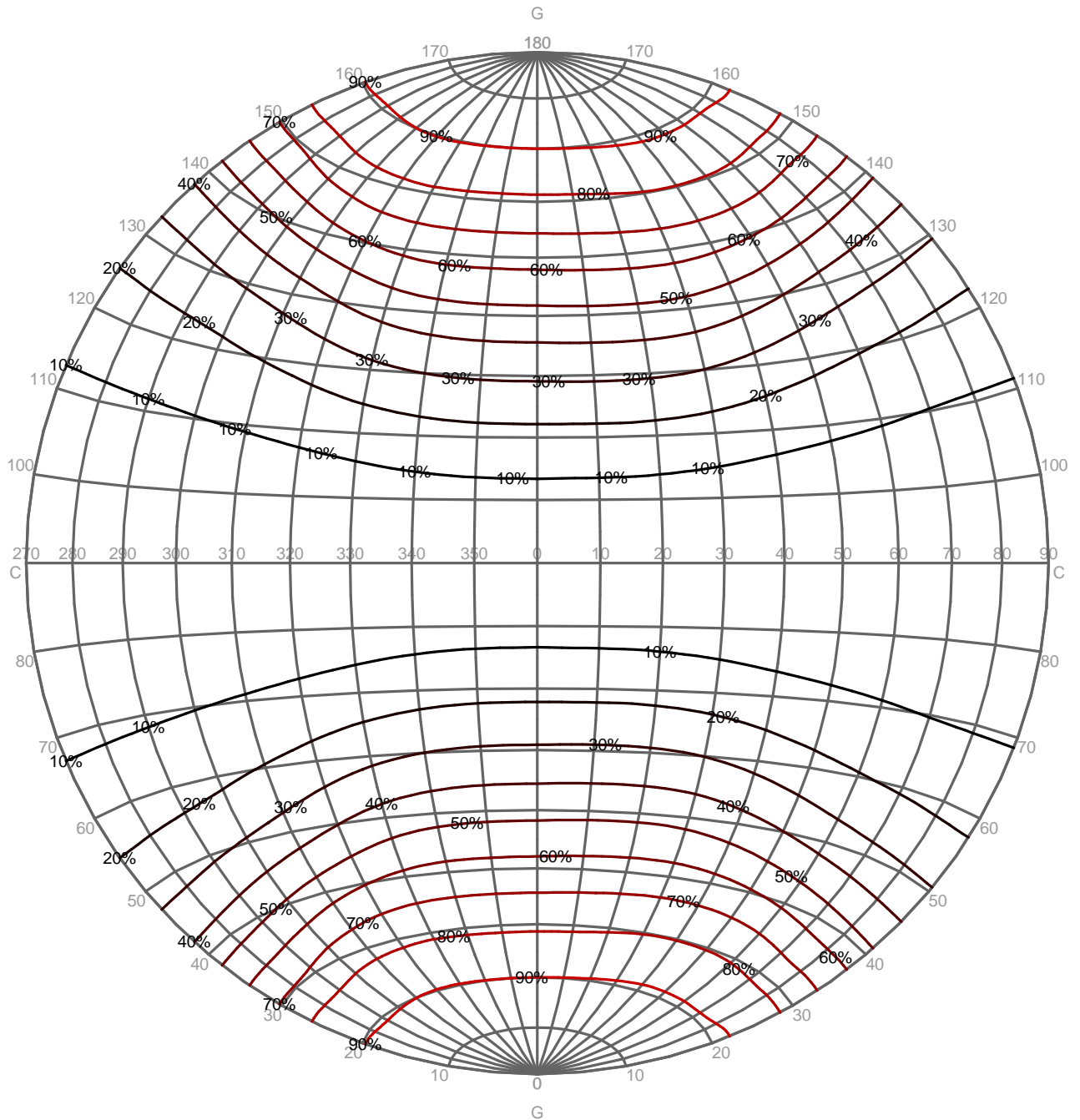

Luminaire

Code 05-9911-34-CL
 Name Aplique AFRODITA 17.5W 3000K

Measur.

Code 05-9911-34-CL
 Name Aplique AFRODITA 17.5W 3000K

Luminaire Flux	1494.40 lm	Luminaire Power	17.00 W	Efficacy	87.91 lm/W	Efficiency	100.00%
Lamps Flux	1494.40 lm	Maximum value	235.88 cd/klm	Position	C=0.00 G=0.00	CG	Asymmetrical

Isolux (Floor)

Luminaire position X=0.00m Y=0.00m Z=2.50m

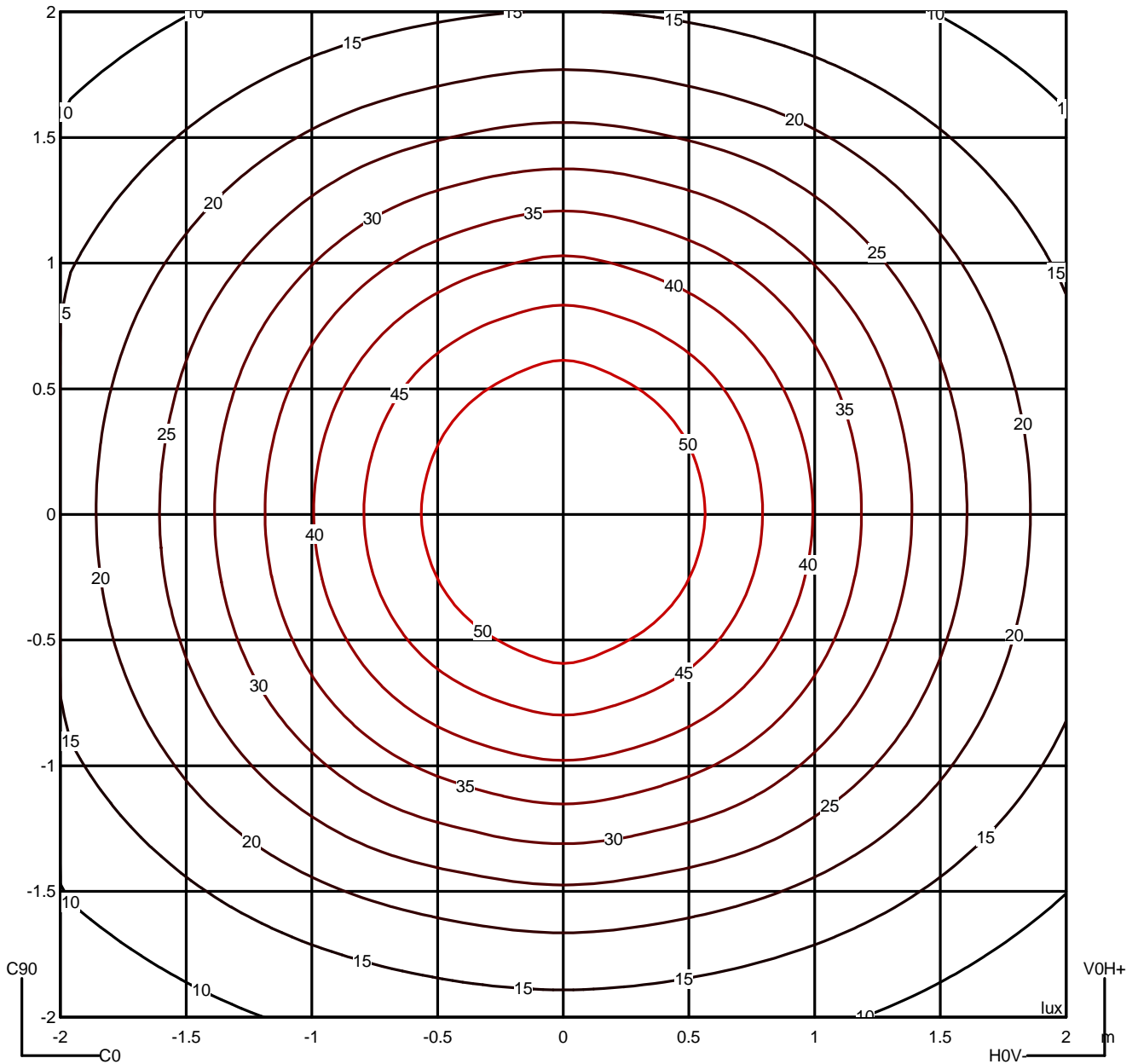

Luminaire

Code 05-9911-34-CL
 Name Applique AFRODITA 17.5W 3000K

Measur.

Code 05-9911-34-CL
 Name Applique AFRODITA 17.5W 3000K

Luminaire Flux	1494.40 lm	Luminaire Power	17.00 W	Efficacy	87.91 lm/W	Efficiency	100.00%
Lamps Flux	1494.40 lm	Maximum value	235.88 cd/klm	Position	C=0.00 G=0.00	CG	Asymmetrical

		Average Luminance [cd/m ²]									
		45°	50°	55°	60°	65°	70°	75°	80°	85°	
0.0°		22261	19659	17037	14388	11718	9110	6705	4632	2716	---
90.0°		8145	6028	4421	3279	2408	1746	1103	617	161	---

Flush mounted or longitudinal view												
		Illumination(lx)										
A	A	2000	1000	750	500	<300						1.15
B	1		2000	1500	1000	750	<300					1.5
C					2000		1000	500	<300			1.85
D	2						2000	1000	500	<300		2.2
E	3							2000	1000	500	<300	2.55

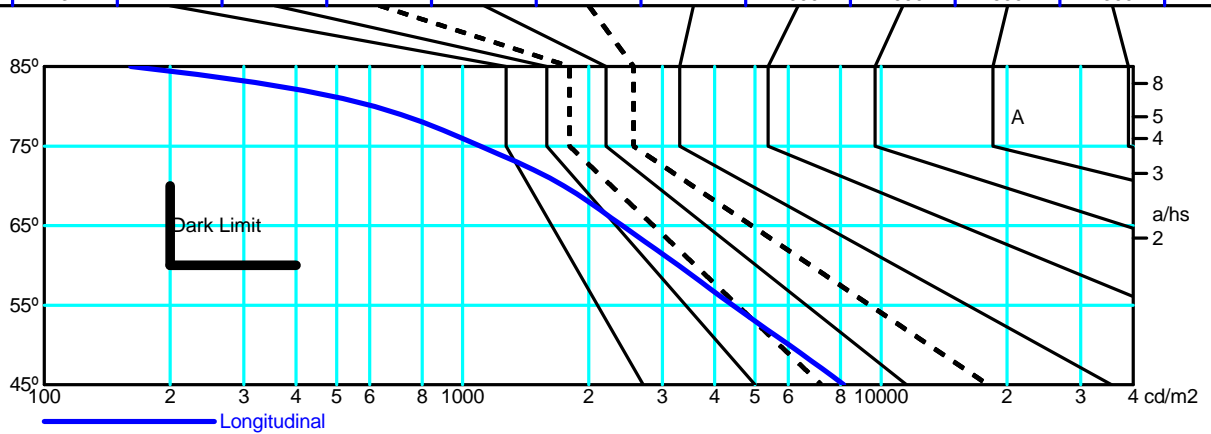

Flush mounted or transversal view												
		Illumination(lx)										
A	A	2000	1000	750	500	<300						1.15
B	1		2000	1500	1000	750	500	<300				1.5
C					2000		1000	500	<300			1.85
D	2						2000	1000	500	<300		2.2
E	3							2000	1000	500	<300	2.55

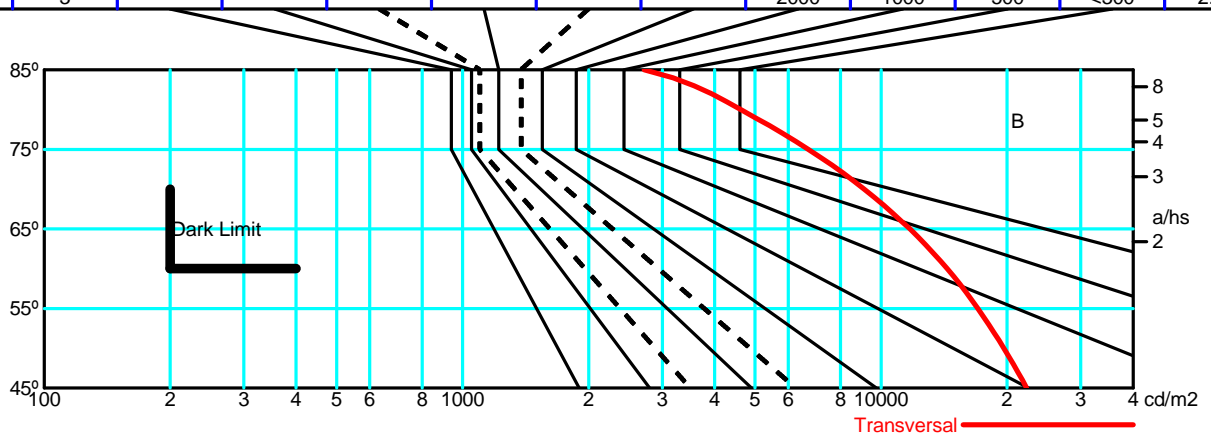

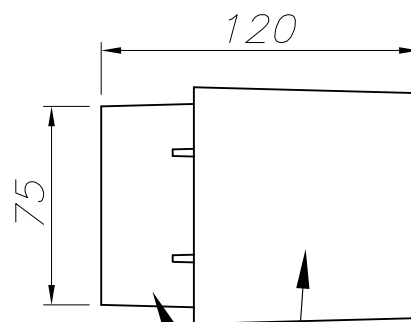
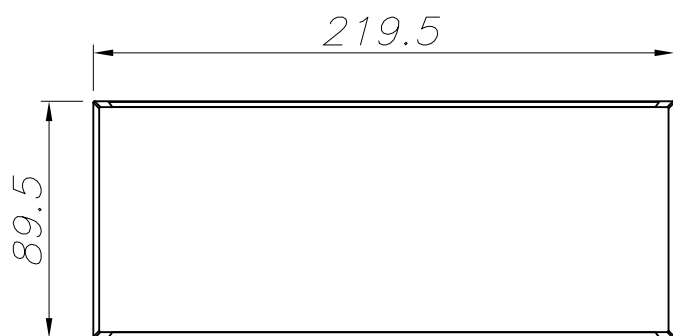

ALUMINIO INYECTADO
INJECTED ALUMINUM

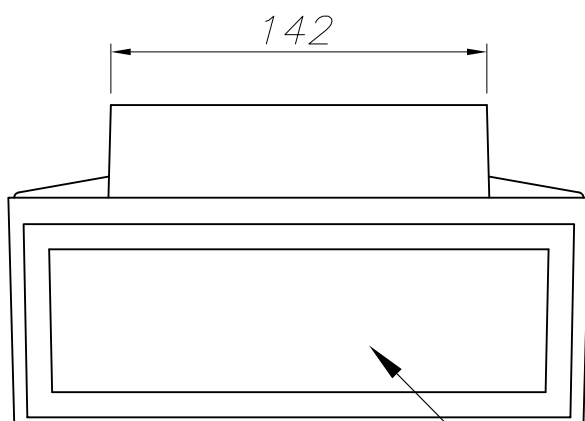

CRISTAL ARENADO INTERIOR
GLASS SANDFROSTED INSIDE

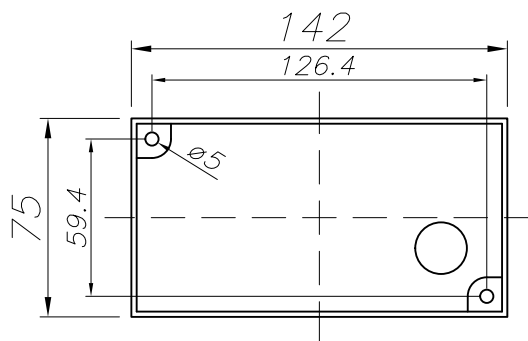

PLANTILLA DE INSTALACIÓN
INSTALLATION TEMPLATE

