

ALIVE Pendant

Designer: Francesc Vilaró

00-6028-21-F1U V0



Finish
Chrome
Transparent
Tinted
NA

Material
Aluminium
Steel
Glass
Methacrylate

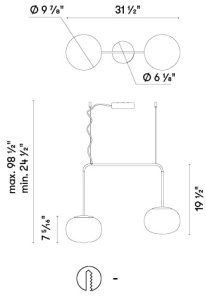

TECHNICAL CHARACTERISTICS

Light source

Light source: LED CREE
Output (W): 14.00W
Total power consumption (W): 16.5 W
Color temperature: LED neutral-white 3500K
CRI: 80
Photobiological risk: RG2
Qty Leds: 2
Life Time: 60.000h L80B20
Bin / Grup: 35H

GEAR

Brand: INVENTRONICS
Gear included: Yes, electronic
Power Factor: 0.99
Dimming protocol: 0-10V

Luminaire

Warranty: 5 Years

Logistics

Energy Efficiency: NA
EAN Code: 8435575305243
Net Weight (Lb): 6.12
Weight in Kg (packaged): 5.795
Packing: - x - x -
Masterbox: 1

The photograph may not match the reference exactly. Please read the product description to identify the finish.

LEDS C4

Luminaire

Code 00-6028-21-F1U
Name Colgante led ALIVE 14W

Measurment.

Code 00-5285
Name Colgante led ALIVE 14W

Luminaire Flux	980.34 lm	Luminaire Power	14.00 W	Efficacy	70.02 lm/W	Efficiency	100.00%
Lamps Flux	980.34 lm	Maximum value	429.72 cd/klm	Position	C=0.00 G=0.00	CG	Double Symmetrical
Round Luminaire Round Luminous Area	Diam. 250 mm Diam. 250 mm	Height	562 mm	Height	180 mm		
Horizontal Luminous Area Emitting area on Plane 0° Emitting area on Plane 90°	0.049087 m2 0.045000 m2 0.045000 m2	Emitting area on Plane 180° Emitting area on Plane 270° Glare area at 76°				0.045000 m2 0.045000 m2 0.055539 m2	
Coordinate system Date Measurement Distance	CG 19-02-2018 0.00	Symmetry Type Maximum Gamma Angle Measurement Flux				Double Symmetrical 180 490.17 lm	
Operator Temperature Humidity Notes	LEDS 25.00 °C 60.00 %	Source Voltage [V] Source current [A] Photocell					

Line	Code	Luminaire Lamps Name	Flux [lm]	Pow. [W]	Q.ty
	00-6028-21-F1U	00-6028-21-F1U	490.17	7.00	2
C.I.E. F UTE	50 78 95 85 100 0.85 D + 0.15 T	D DIN 5040 B NBN	B31 BZ 4		

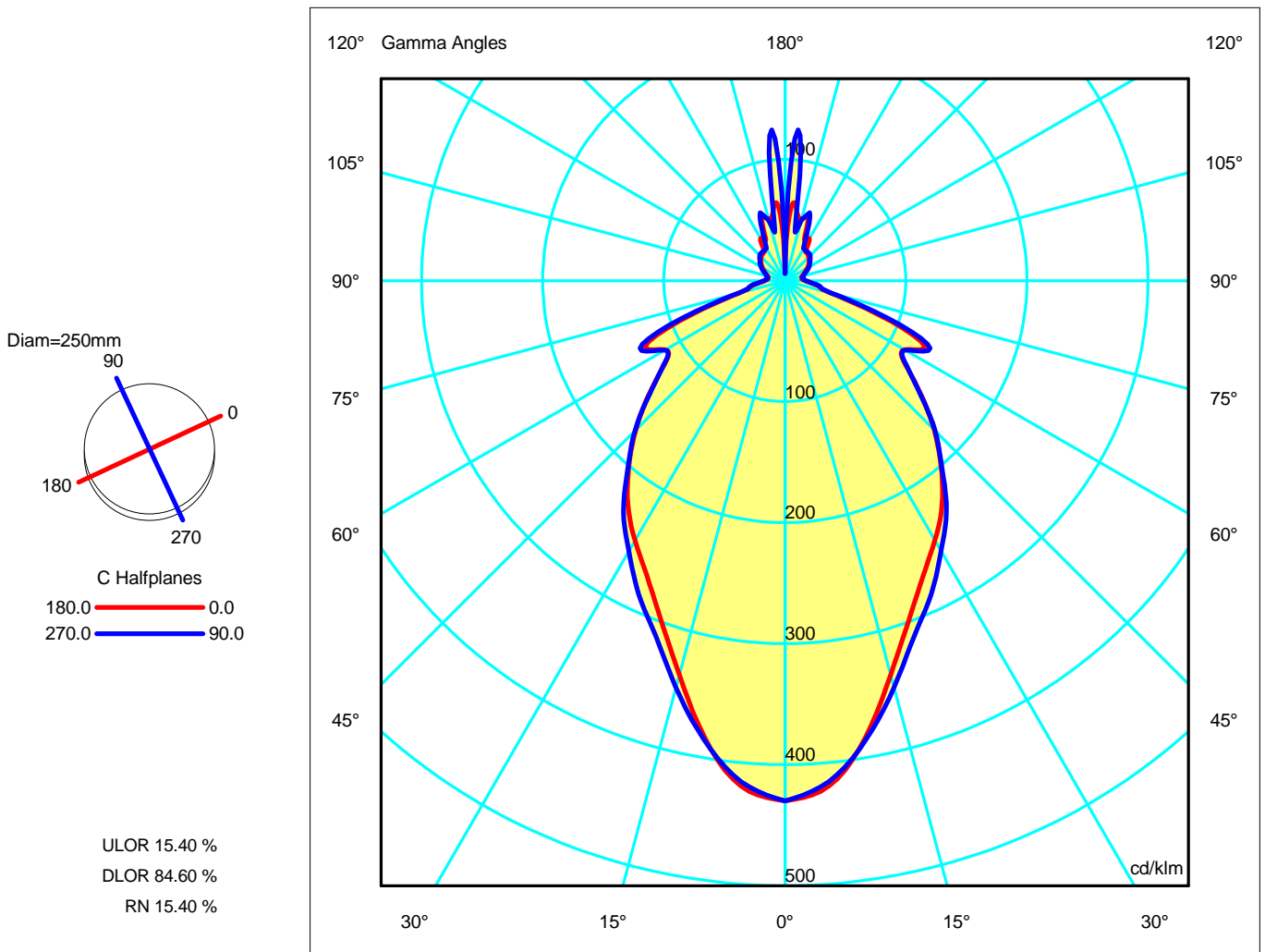

Luminaire

Code 00-6028-21-F1U
Name Colgante led ALIVE 14W

Measur.

Code 00-5285
Name Colgante led ALIVE 14W

Luminaire Flux	980.34 lm	Luminaire Power	14.00 W	Efficacy	70.02 lm/W	Efficiency	100.00%
Lamps Flux	980.34 lm	Maximum value	429.72 cd/klm	Position	C=0.00 G=0.00	CG	Double Symmetrical

Luminous Intensity Table cd/klm Table 1/1

	C 0.00	C 15.00	C 30.00	C 45.00	C 60.00	C 75.00	C 90.00
G 0.0	429.72	429.72	429.72	429.72	429.72	429.72	429.72
G 5.0	419.07	418.27	422.18	415.44	418.66	414.31	415.49
G 10.0	383.04	384.07	393.74	377.22	388.62	374.96	385.15
G 15.0	337.15	338.23	352.64	337.29	346.45	334.10	347.95
G 20.0	298.86	299.01	313.79	301.77	313.63	301.75	312.30
G 25.0	269.59	270.57	282.69	275.76	282.46	276.28	285.82
G 30.0	247.76	247.83	257.98	252.74	259.71	252.97	257.85
G 35.0	226.16	224.98	232.35	228.56	231.22	227.85	232.57
G 40.0	200.59	200.81	205.89	202.01	206.11	199.81	201.60
G 45.0	174.21	173.87	177.24	173.68	175.09	171.33	175.25
G 50.0	146.86	146.46	149.22	146.53	149.23	143.83	146.07
G 55.0	121.95	121.88	124.25	122.39	123.22	121.09	122.72
G 60.0	114.10	118.70	118.92	119.73	116.53	119.46	114.80
G 65.0	127.20	124.73	130.96	125.96	131.50	126.64	132.15
G 70.0	82.38	81.89	87.37	82.75	90.66	83.64	90.14
G 75.0	38.36	39.17	40.38	40.38	40.46	42.60	39.81
G 80.0	28.62	28.58	29.46	29.31	29.72	29.36	29.94
G 85.0	21.48	21.63	22.50	21.95	22.82	22.20	22.62
G 90.0	16.51	16.67	17.20	17.03	17.09	17.30	17.46
G 95.0	14.24	14.29	14.83	14.67	15.02	14.80	14.99
G100.0	13.95	13.93	14.43	14.23	14.65	14.45	14.70
G105.0	14.82	14.80	15.36	15.12	15.56	15.36	15.77
G110.0	16.64	16.57	17.40	17.09	17.83	17.33	17.54
G115.0	19.00	19.13	19.78	19.60	20.10	19.60	20.22
G120.0	21.73	21.55	22.58	21.93	22.84	22.23	22.88
G125.0	24.07	23.80	24.74	24.29	24.90	24.60	25.14
G130.0	26.10	25.96	26.88	26.28	27.16	26.57	27.19
G135.0	27.79	27.65	28.54	27.88	28.81	28.41	29.34
G140.0	28.95	28.78	29.45	29.03	29.85	29.56	30.18
G145.0	29.27	29.05	29.93	29.38	30.18	29.62	30.31
G150.0	40.33	32.84	31.91	32.40	31.08	32.52	30.69
G155.0	37.64	43.26	39.66	38.85	40.57	42.46	42.91
G160.0	56.61	42.65	51.00	39.67	56.12	54.45	59.64
G165.0	52.64	49.14	46.97	43.59	50.73	53.22	51.33
G170.0	57.53	52.50	51.14	54.93	52.16	58.27	52.65
G175.0	61.34	71.94	81.99	61.39	73.65	73.19	125.11
G180.0	6.09	6.09	6.09	6.09	6.09	6.09	6.09

LEDS C4[®]

Luminaire

Code 00-6028-21-F1U
 Name Colgante led ALIVE 14W

Measur.

Code 00-5285
 Name Colgante led ALIVE 14W

Luminaire Flux	980.34 lm	Luminaire Power	14.00 W	Efficacy	70.02 lm/W	Efficiency	100.00%
Lamps Flux	980.34 lm	Maximum value	429.72 cd/klm	Position	C=0.00 G=0.00	CG	Double Symmetrical

Diam=250mm

C Halfplanes

180.0 ——— 0.0
 270.0 ——— 90.0

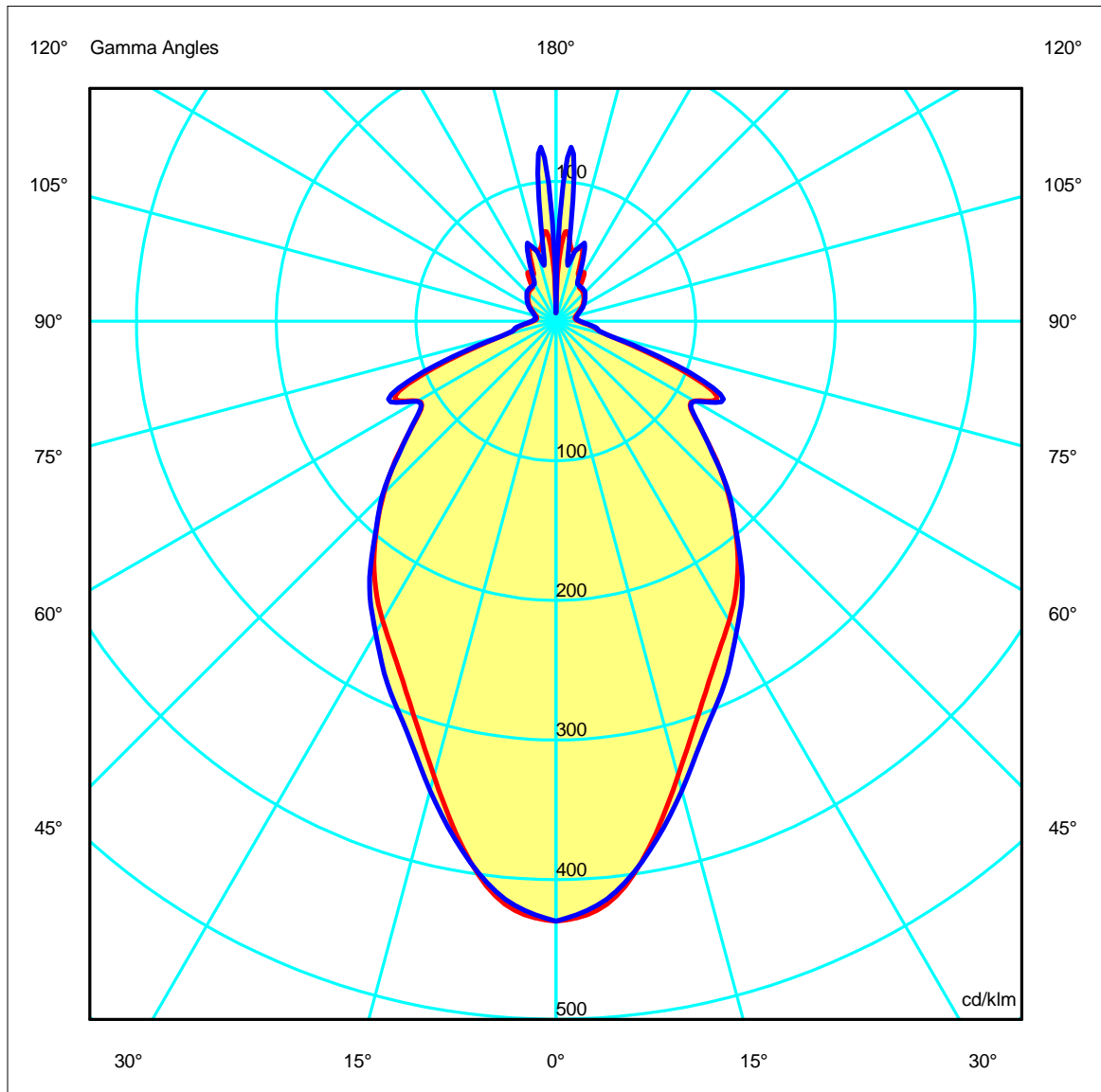
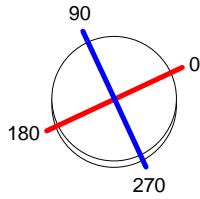

LEDS C4[®]

Luminaire

Code 00-6028-21-F1U
Name Colgante led ALIVE 14W

Measur.

Code 00-5285
Name Colgante led ALIVE 14W

Luminaire Flux	980.34 lm	Luminaire Power	14.00 W	Efficacy	70.02 lm/W	Efficiency	100.00%
Lamps Flux	980.34 lm	Maximum value	429.72 cd/klm	Position	C=0.00 G=0.00	CG	Double Symmetrical

Width at 50.00 % of Max Intensity

H[m]	1.00	2.00	3.00	4.00	5.00	H[m]	1.00	2.00	3.00	4.00	5.00
OA	0.76	1.52	2.28	3.04	3.81	OC	0.78	1.55	2.33	3.11	3.89
OB	0.76	1.52	2.28	3.04	3.81	OD	0.78	1.55	2.33	3.11	3.89

	Luminous Intensities [cd/klm]									
	0	5	15	25	35	45	55	65	75	85
OA	421.27	410.84	330.52	264.28	221.72	170.78	119.55	124.70	37.61	21.05
OB	421.27	410.84	330.52	264.28	221.72	170.78	119.55	124.70	37.61	21.05
OC	421.27	407.32	341.11	280.21	228.00	171.81	120.31	129.56	39.03	22.17
OD	421.27	407.32	341.11	280.21	228.00	171.81	120.31	129.56	39.03	22.17

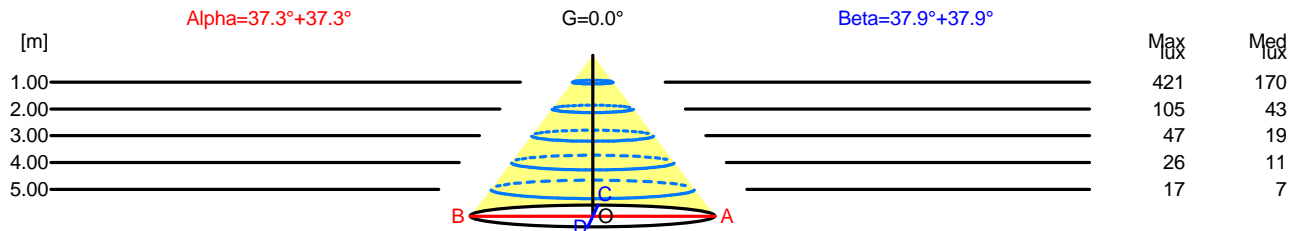

H[m]	D[m]	Max lux	Med lux	Alpha=37.3°+37.3°	G=0.0
1.00	1.52	421	170		
2.00	3.04	105	43		
3.00	4.57	47	19		
4.00	6.09	26	11		
5.00	7.61	17	7		

H[m]	D[m]	Max lux	Med lux	Beta=37.9°+37.9°	G=0.0
1.00	1.55	421	170		
2.00	3.11	105	43		
3.00	4.66	47	19		
4.00	6.22	26	11		
5.00	7.77	17	7		

Luminaire

Code 00-6028-21-F1U
Name Colgante led ALIVE 14W

Measurement

Code 00-5285
Name Colgante led ALIVE 14W

Luminaire Flux	980.34 lm	Luminaire Power	14.00 W	Efficacy	70.02 lm/W	Efficiency	100.00%
Lamps Flux	980.34 lm	Maximum value	429.72 cd/klm	Position	C=0.00 G=0.00	CG	Double Symmetrical

UGR
S = 0.250

Reflectancies										
Ceiling/Cavity	0.7	0.7	0.5	0.5	0.3	0.7	0.7	0.5	0.5	0.3
Walls	0.5	0.3	0.5	0.3	0.3	0.5	0.3	0.5	0.3	0.3
WorkingPlane	0.2	0.2	0.2	0.2	0.2	0.2	0.2	0.2	0.2	0.2
RoomDimensions	Viewed Crosswise					Viewed Endwise				
x=2H y=2H	13.8	14.9	14.3	15.3	15.9	13.8	14.9	14.3	15.3	15.9
x=2H y=3H	15.4	16.4	16.0	17.0	17.5	15.5	16.5	16.1	17.0	17.6
x=2H y=4H	15.6	16.6	16.2	17.1	17.7	15.8	16.7	16.3	17.2	17.8
x=2H y=6H	15.7	16.6	16.3	17.1	17.8	15.8	16.7	16.4	17.3	17.9
x=2H y=8H	15.8	16.6	16.3	17.1	17.8	15.9	16.7	16.5	17.3	17.9
x=2H y=12H	15.8	16.6	16.4	17.1	17.8	15.9	16.7	16.5	17.3	17.9
x=4H y=2H	14.6	15.6	15.2	16.1	16.7	14.6	15.6	15.2	16.1	16.7
x=4H y=3H	16.3	17.1	16.9	17.7	18.3	16.4	17.2	17.0	17.7	18.4
x=4H y=4H	16.5	17.2	17.1	17.8	18.5	16.6	17.3	17.2	17.9	18.6
x=4H y=6H	16.6	17.3	17.3	17.9	18.6	16.8	17.4	17.4	18.0	18.7
x=4H y=8H	16.7	17.3	17.4	17.9	18.7	16.8	17.4	17.5	18.0	18.8
x=4H y=12H	16.8	17.3	17.5	17.9	18.7	16.9	17.4	17.6	18.1	18.8
x=8H y=4H	16.6	17.2	17.3	17.8	18.5	16.7	17.3	17.4	17.9	18.6
x=8H y=6H	16.8	17.3	17.5	17.9	18.7	16.9	17.4	17.6	18.1	18.8
x=8H y=8H	16.9	17.3	17.6	18.0	18.8	17.1	17.5	17.8	18.1	18.9
x=8H y=12H	17.1	17.4	17.8	18.1	18.9	17.2	17.5	17.9	18.2	19.0
x=12H y=4H	16.6	17.1	17.2	17.7	18.5	16.7	17.2	17.3	17.8	18.6
x=12H y=6H	16.8	17.2	17.5	17.9	18.7	16.9	17.3	17.6	18.0	18.8
x=12H y=8H	17.0	17.3	17.7	18.0	18.8	17.1	17.4	17.8	18.1	18.9

LEDS C4[®]

Luminaire

Code 00-6028-21-F1U
Name Colgante led ALIVE 14W

Measur.

Code 00-5285
Name Colgante led ALIVE 14W

Luminaire Flux	980.34 lm	Luminaire Power	14.00 W	Efficacy	70.02 lm/W	Efficiency	100.00%
Lamps Flux	980.34 lm	Maximum value	429.72 cd/klm	Position	C=0.00 G=0.00	CG	Double Symmetrical

Diam=250mm

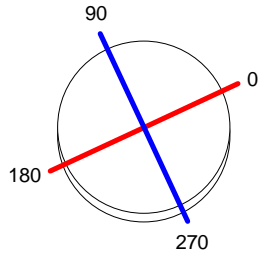

C Halfplanes

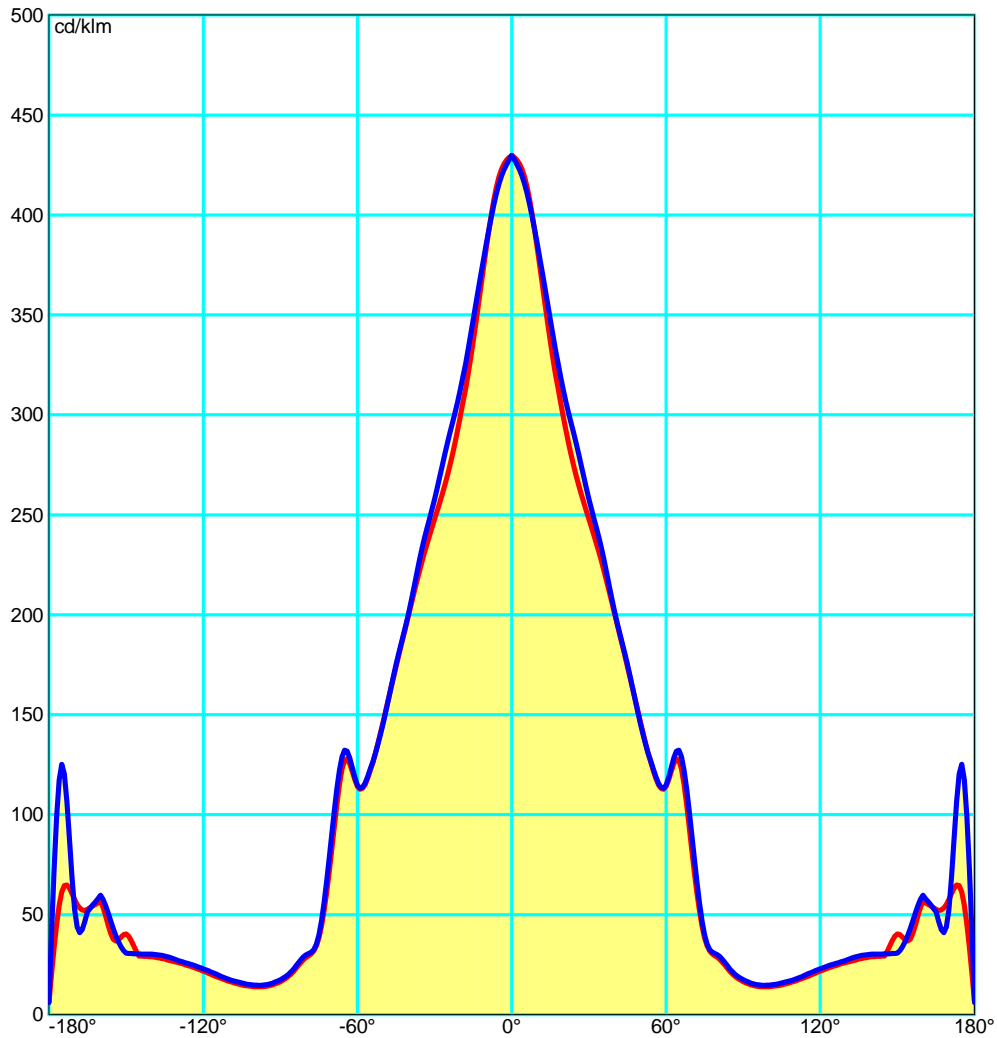

LEDS C4[®]

Luminaire

Code 00-6028-21-F1U
Name Colgante led ALIVE 14W

Measur.

Code 00-5285
Name Colgante led ALIVE 14W

Luminaire Flux	980.34 lm	Luminaire Power	14.00 W	Efficacy	70.02 lm/W	Efficiency	100.00%
Lamps Flux	980.34 lm	Maximum value	429.72 cd/klm	Position	C=0.00 G=0.00	CG	Double Symmetrical

Luminance

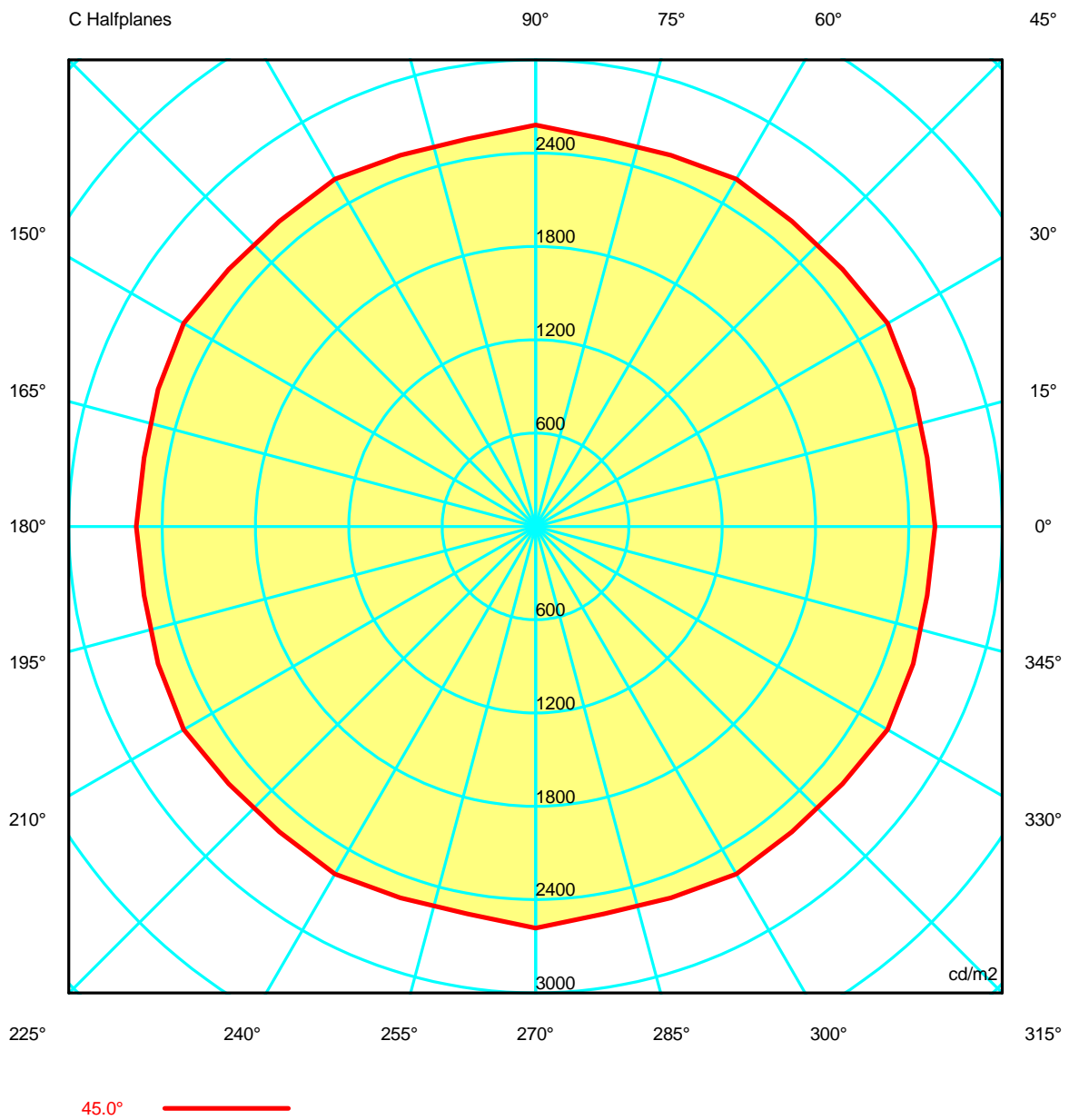

Luminaire

Code 00-6028-21-F1U
Name Colgante led ALIVE 14W

Measurerm.

Code 00-5285
Name Colgante led ALIVE 14W

Luminaire Flux	980.34 lm	Luminaire Power	14.00 W	Efficacy	70.02 lm/W	Efficiency	100.00%
Lamps Flux	980.34 lm	Maximum value	429.72 cd/klm	Position	C=0.00 G=0.00	CG	Double Symmetrical

Luminance cd/m2 Table 1/3

	C 0.00	C 10.00	C 20.00	C 30.00	C 40.00	C 50.00	C 60.00	C 70.00	C 80.00	C 90.00	C 100.00	C 110.00	C 120.00
G 0.0	8582.17	8582.17	8582.17	8582.17	8582.17	8582.17	8582.17	8582.17	8582.17	8582.17	8582.17	8582.17	8582.17
G 5.0	7777.70	7752.24	7795.39	7835.40	7745.06	7719.04	7770.00	7720.22	7680.93	7711.22	7680.93	7720.22	7770.00
G 10.0	6687.01	6698.98	6786.15	6873.82	6656.35	6630.23	6784.39	6628.21	6547.81	6723.84	6547.81	6628.21	6784.39
G 15.0	5596.24	5608.24	5713.89	5853.29	5669.92	5629.12	5750.61	5609.57	5565.62	5775.49	5565.62	5609.57	5750.61
G 20.0	4762.64	4764.17	4858.16	5000.46	4857.79	4855.57	4997.98	4874.07	4815.61	4976.86	4815.61	4874.07	4997.98
G 25.0	4161.59	4171.76	4247.38	4363.89	4288.16	4280.84	4360.29	4294.08	4282.49	4412.28	4282.49	4294.08	4360.29
G 30.0	3736.17	3736.84	3793.86	3890.24	3831.75	3838.95	3916.42	3851.05	3814.48	3888.25	3814.48	3851.05	3916.42
G 35.0	3358.29	3328.60	3378.93	3450.14	3413.10	3401.32	3433.32	3398.22	3391.39	3453.47	3391.39	3398.22	3433.32
G 40.0	2955.88	2958.02	2988.78	3033.91	2990.29	2994.00	3037.19	2977.46	2936.11	2970.67	2936.11	2977.46	3037.19
G 45.0	2567.01	2554.78	2581.87	2611.74	2574.76	2563.31	2580.08	2540.38	2529.88	2582.45	2529.88	2540.38	2580.08
G 50.0	2180.64	2169.02	2191.30	2215.64	2184.15	2188.64	2215.83	2162.20	2131.50	2168.86	2131.50	2162.20	2215.83
G 55.0	1838.78	1832.28	1851.30	1873.40	1854.21	1847.92	1857.89	1835.62	1826.79	1850.44	1826.79	1835.62	1857.89
G 60.0	1761.13	1816.03	1833.21	1835.52	1850.36	1830.34	1798.68	1831.32	1834.49	1771.86	1834.49	1831.32	1798.68
G 65.0	2026.66	1980.38	2023.63	2086.64	2026.85	2029.18	2095.20	2043.93	2024.66	2105.60	2024.66	2043.93	2095.20
G 70.0	1367.07	1345.34	1395.91	1449.90	1385.34	1412.37	1504.52	1427.86	1393.19	1495.85	1393.19	1427.86	1504.52
G 75.0	669.50	677.79	691.19	704.82	704.81	701.35	706.09	735.72	736.68	694.79	736.68	735.72	706.09
G 80.0	530.97	528.15	535.68	546.54	544.77	546.06	551.48	546.71	546.04	555.41	546.04	546.71	551.48
G 85.0	428.75	430.78	438.72	449.19	440.54	442.91	455.58	448.00	442.82	451.47	442.82	448.00	455.58
G 90.0	359.60	360.73	367.35	374.77	372.29	370.47	372.35	375.45	378.21	380.40	378.21	375.45	372.35

Luminaire

Code 00-6028-21-F1U
Name Colgante led ALIVE 14W

Measurerm.

Code 00-5285
Name Colgante led ALIVE 14W

Luminaire Flux	980.34 lm	Luminaire Power	14.00 W	Efficacy	70.02 lm/W	Efficiency	100.00%
Lamps Flux	980.34 lm	Maximum value	429.72 cd/klm	Position	C=0.00 G=0.00	CG	Double Symmetrical

Luminance cd/m2 Table 2/3

	C 130.00	C 140.00	C 150.00	C 160.00	C 170.00	C 180.00	C 190.00	C 200.00	C 210.00	C 220.00	C 230.00	C 240.00	C 250.00
G 0.0	8582.17	8582.17	8582.17	8582.17	8582.17	8582.17	8582.17	8582.17	8582.17	8582.17	8582.17	8582.17	8582.17
G 5.0	7719.04	7745.06	7835.40	7795.39	7752.24	7777.70	7752.24	7795.39	7835.40	7745.06	7719.04	7770.00	7720.22
G 10.0	6630.23	6656.35	6873.82	6786.15	6698.98	6687.01	6698.98	6786.15	6873.82	6656.35	6630.23	6784.39	6628.21
G 15.0	5629.12	5669.92	5853.29	5713.89	5608.24	5596.24	5608.24	5713.89	5853.29	5669.92	5629.12	5750.61	5609.57
G 20.0	4855.57	4857.79	5000.46	4858.16	4764.17	4762.64	4764.17	4858.16	5000.46	4857.79	4855.57	4997.98	4874.07
G 25.0	4280.84	4288.16	4363.89	4247.38	4171.76	4161.59	4171.76	4247.38	4363.89	4288.16	4280.84	4360.29	4294.08
G 30.0	3838.95	3831.75	3890.24	3793.86	3736.84	3736.17	3736.84	3793.86	3890.24	3831.75	3838.95	3916.42	3851.05
G 35.0	3401.32	3413.10	3450.14	3378.93	3328.60	3358.29	3328.60	3378.93	3450.14	3413.10	3401.32	3433.32	3398.22
G 40.0	2994.00	2990.29	3033.91	2988.78	2958.02	2955.88	2958.02	2988.78	3033.91	2990.29	2994.00	3037.19	2977.46
G 45.0	2563.31	2574.76	2611.74	2581.87	2554.78	2567.01	2554.78	2581.87	2611.74	2574.76	2563.31	2580.08	2540.38
G 50.0	2188.64	2184.15	2215.64	2191.30	2169.02	2180.64	2169.02	2191.30	2215.64	2184.15	2188.64	2215.83	2162.20
G 55.0	1847.92	1854.21	1873.40	1851.30	1832.28	1838.78	1832.28	1851.30	1873.40	1854.21	1847.92	1857.89	1835.62
G 60.0	1830.34	1850.36	1835.52	1833.21	1816.03	1761.13	1816.03	1833.21	1835.52	1850.36	1830.34	1798.68	1831.32
G 65.0	2029.18	2026.85	2086.64	2023.63	1980.38	2026.66	1980.38	2023.63	2086.64	2026.85	2029.18	2095.20	2043.93
G 70.0	1412.37	1385.34	1449.90	1395.91	1345.34	1367.07	1345.34	1395.91	1449.90	1385.34	1412.37	1504.52	1427.86
G 75.0	701.35	704.81	704.82	691.19	677.79	669.50	677.79	691.19	704.81	704.81	701.35	706.09	735.72
G 80.0	546.06	544.77	546.54	535.68	528.15	530.97	528.15	535.68	546.54	544.77	546.06	551.48	546.71
G 85.0	442.91	440.54	449.19	438.72	430.78	428.75	430.78	438.72	449.19	440.54	442.91	455.58	448.00
G 90.0	370.47	372.29	374.77	367.35	360.73	359.60	360.73	367.35	374.77	372.29	370.47	372.35	375.45

Luminaire

Code 00-6028-21-F1U
Name Colgante led ALIVE 14W

Measur.

Code 00-5285
Name Colgante led ALIVE 14W

Luminaire Flux	980.34 lm	Luminaire Power	14.00 W	Efficacy	70.02 lm/W	Efficiency	100.00%
Lamps Flux	980.34 lm	Maximum value	429.72 cd/klm	Position	C=0.00 G=0.00	CG	Double Symmetrical

Luminance cd/m2 Table 3/3

	C 260.00	C 270.00	C 280.00	C 290.00	C 300.00	C 310.00	C 320.00	C 330.00	C 340.00	C 350.00
G 0.0	8582.17	8582.17	8582.17	8582.17	8582.17	8582.17	8582.17	8582.17	8582.17	8582.17
G 5.0	7680.93	7711.22	7680.93	7720.22	7770.00	7719.04	7745.06	7835.40	7795.39	7752.24
G 10.0	6547.81	6723.84	6547.81	6628.21	6784.39	6630.23	6656.35	6873.82	6786.15	6698.98
G 15.0	5565.62	5775.49	5565.62	5609.57	5750.61	5629.12	5669.92	5853.29	5713.89	5608.24
G 20.0	4815.61	4976.86	4815.61	4874.07	4997.98	4855.57	4857.79	5000.46	4858.16	4764.17
G 25.0	4282.49	4412.28	4282.49	4294.08	4360.29	4280.84	4288.16	4363.89	4247.38	4171.76
G 30.0	3814.48	3888.25	3814.48	3851.05	3916.42	3838.95	3831.75	3890.24	3793.86	3736.84
G 35.0	3391.39	3453.47	3391.39	3398.22	3433.32	3401.32	3413.10	3450.14	3378.93	3328.60
G 40.0	2936.11	2970.67	2936.11	2977.46	3037.19	2994.00	2990.29	3033.91	2988.78	2958.02
G 45.0	2529.88	2582.45	2529.88	2540.38	2580.08	2563.31	2574.76	2611.74	2581.87	2554.78
G 50.0	2131.50	2168.86	2131.50	2162.20	2215.83	2188.64	2184.15	2215.64	2191.30	2169.02
G 55.0	1826.79	1850.44	1826.79	1835.62	1857.89	1847.92	1854.21	1873.40	1851.30	1832.28
G 60.0	1834.49	1771.86	1834.49	1831.32	1798.68	1830.34	1850.36	1835.52	1833.21	1816.03
G 65.0	2024.66	2105.60	2024.66	2043.93	2095.20	2029.18	2026.85	2086.64	2023.63	1980.38
G 70.0	1393.19	1495.85	1393.19	1427.86	1504.52	1412.37	1385.34	1449.90	1395.91	1345.34
G 75.0	736.68	694.79	736.68	735.72	706.09	701.35	704.81	704.82	691.19	677.79
G 80.0	546.04	555.41	546.04	546.71	551.48	546.06	544.77	546.54	535.68	528.15
G 85.0	442.82	451.47	442.82	448.00	455.58	442.91	440.54	449.19	438.72	430.78
G 90.0	378.21	380.40	378.21	375.45	372.35	370.47	372.29	374.77	367.35	360.73

Luminaire
 Code 00-6028-21-F1U
 Name Colgante led ALIVE 14W
Measurment.
 Code 00-5285
 Name Colgante led ALIVE 14W

Luminaire Flux	980.34 lm	Luminaire Power	14.00 W	Efficacy	70.02 lm/W	Efficiency	100.00%
Lamps Flux	980.34 lm	Maximum value	429.72 cd/klm	Position	C=0.00 G=0.00	CG	Double Symmetrical

PERCENTAGE ISOCANDLES

Projection: Equal Area SLI 7.0 Tight Tilting Angle:0°

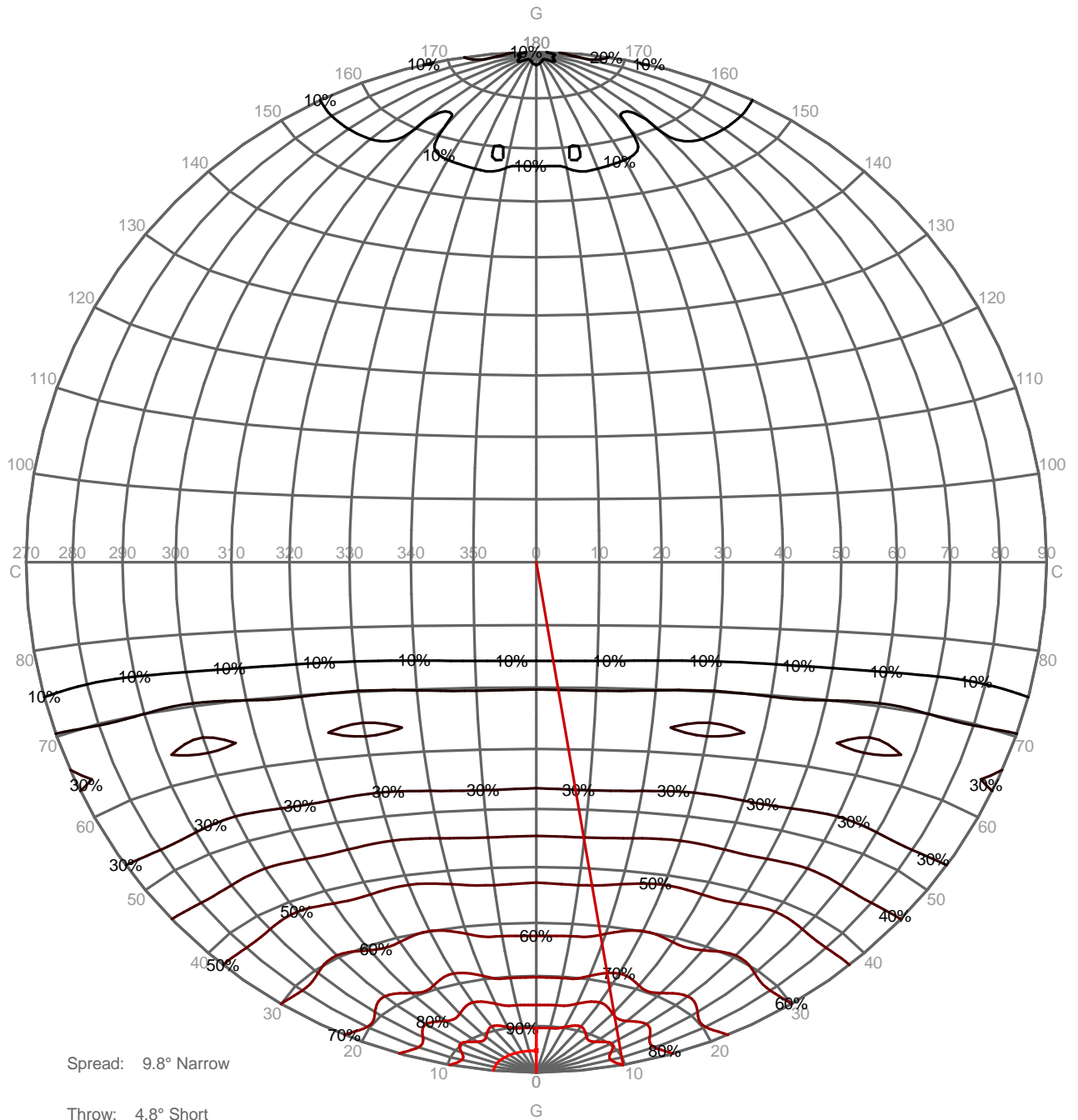

Luminaire
 Code 00-6028-21-F1U
 Name Colgante led ALIVE 14W
Measur.
 Code 00-5285
 Name Colgante led ALIVE 14W

Luminaire Flux	980.34 lm	Luminaire Power	14.00 W	Efficacy	70.02 lm/W	Efficiency	100.00%
Lamps Flux	980.34 lm	Maximum value	429.72 cd/klm	Position	C=0.00 G=0.00	CG	Double Symmetrical

Isolux (Floor)

Luminaire position X=0.00m Y=0.00m Z=2.50m

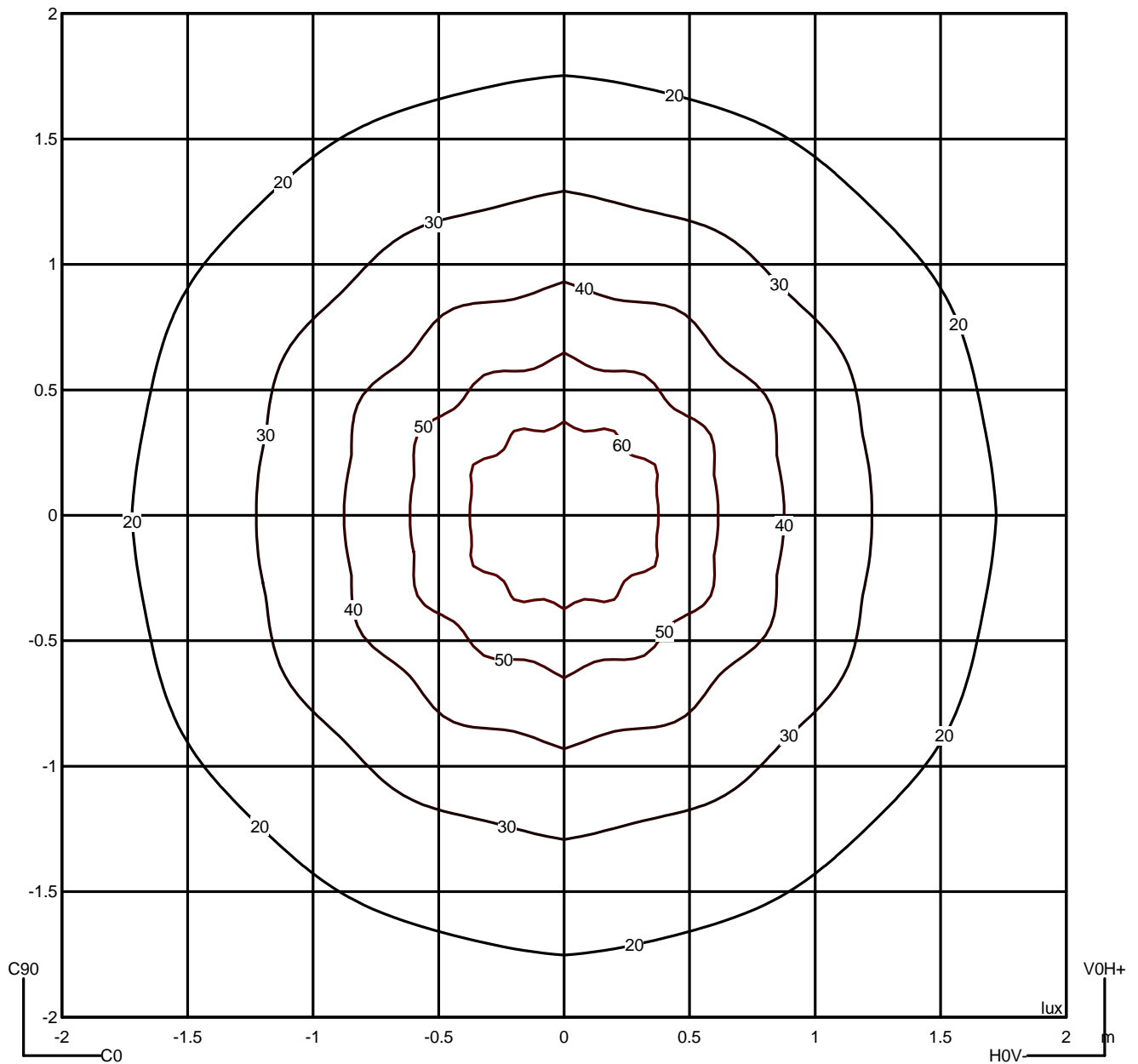

LEDS C4[®]

Luminaire

Code 00-6028-21-F1U
Name Colgante led ALIVE 14W

Measur.

Code 00-5285
Name Colgante led ALIVE 14W

Luminaire Flux	980.34 lm	Luminaire Power	14.00 W	Efficacy	70.02 lm/W	Efficiency	100.00%
Lamps Flux	980.34 lm	Maximum value	429.72 cd/klm	Position	C=0.00 G=0.00	CG	Double Symmetrical

		Average Luminance [cd/m ²]									
		45°	50°	55°	60°	65°	70°	75°	80°	85°	
0.0°	2567	2181	1839	1761	2027	1367	670	531	429	---	
90.0°	2582	2169	1850	1772	2106	1496	695	555	451	---	

Flush mounted or transversal view												
		Illumination(Ix)										
A	A	2000	1000	750	500		<300				1.15	
B	1		2000	1500	1000	750	500	<300			1.5	
C					2000		1000	500	<300		1.85	
D	2						2000	1000	500	<300	2.2	
E	3							2000	1000	500	<300	2.55

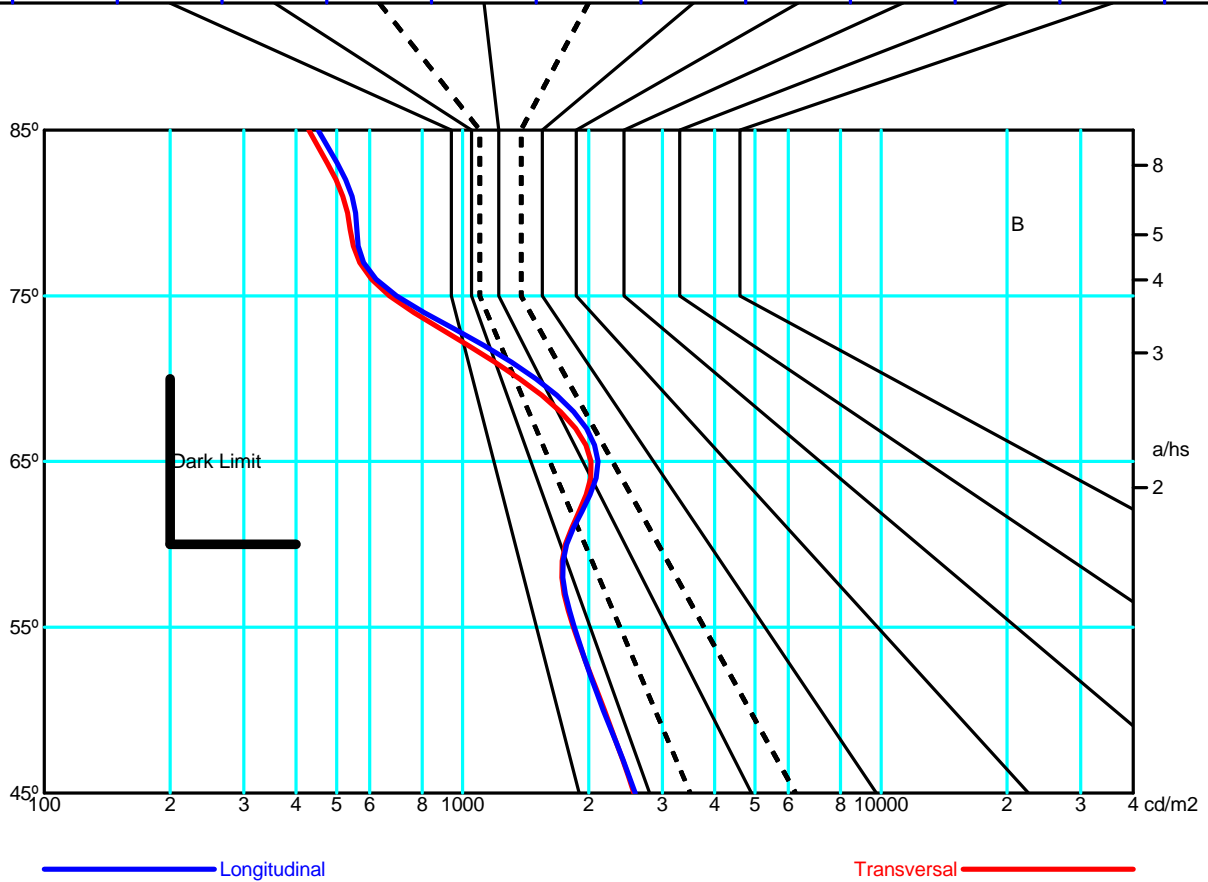

FIGURE N° 1. UNPACK THE FIXTURE: CHECK THE CONTENTS OF THE BOX. YOU SHOULD RECEIVE:

FIGURE N° 1. DÉBALLER LE PLAFONIER: VÉRIFIER LE CONTENU DU CARTON, VOUS DEVEZ RECEVOIR:

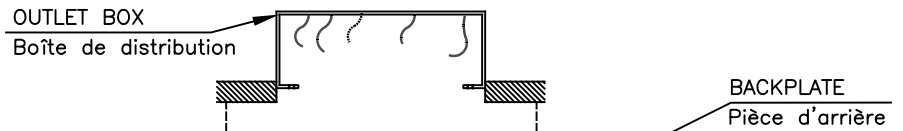
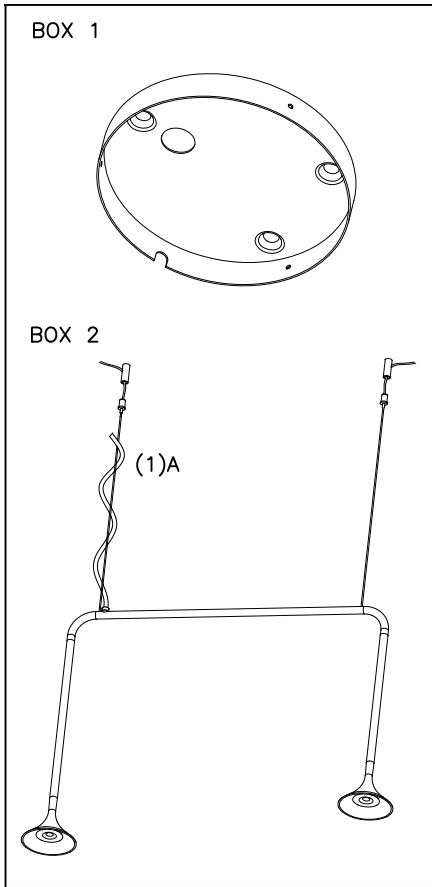
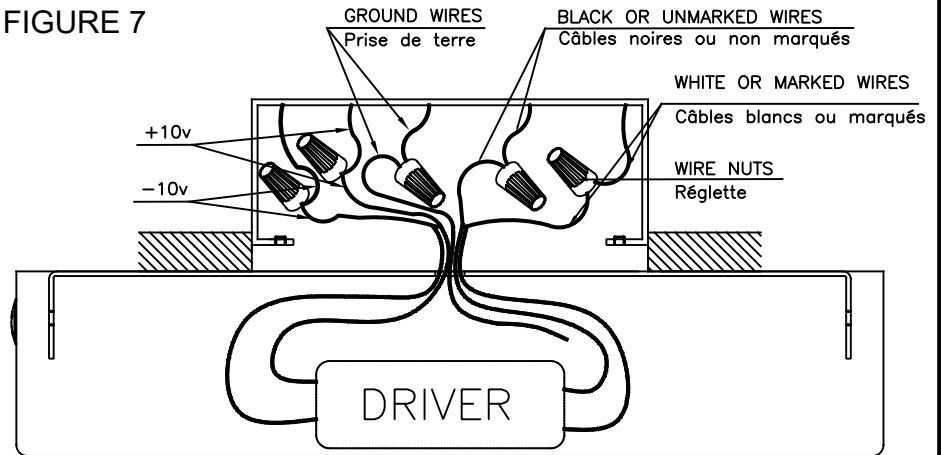

FIGURE 6

FIGURE 7



INSTALLATION INSTRUCTIONS FOR HANGING FIXTURES

FIGURE 3, 4 AND 5 MOUNTING HARDWARE.
NOTE: TEST THE CONNECTOR BY GENTLY PULLING IT. IF IT PULLS OUT THE CONNECTION, TRY AGAIN TILL YOU HAVE A FIRM CONNECTION. MAKE SURE NO BARE STRANDS OF WIRE STICK OUT FROM UNDER THE CONNECTORS.

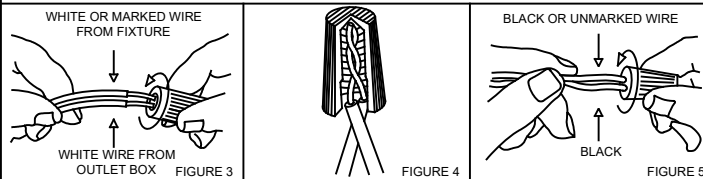

INSTRUCTIONS D'INSTALLATION POUR PLAFONNIERS

FIGURE 3, 4 ET 5 MONTAGE DE L'ÉQUIPE.
IMPORTANT: ESSAYER DE TIRER LE CÂBLE D'ALIMENTATION DOUCEMENT. S'IL SORT DE LA CONNECTION, IL FAUDRAIT ASSURER QUE LA CONNECTION SOIT FERME. S'ASSURER QUE LES FILS DES CÂBLES NE SONT PAS À DÉCOUVERT DU CONNECTEUR.

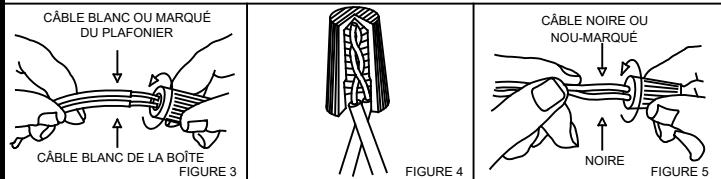

CAUTION:
"Warning", "This product is to be installed by a qualified electrician only."

"Suitable for dry locations only"

ATTENTION:
"Attention", le raccordement électrique sera effectué par un technicien électrique qualifié

"Adéquat seulement en lieux secs."

CAUTION:
1.- Wrong lighting installation can be dangerous for your safety.
2.- Before starting, disconnect the power by turning off the general switch of the electric installation.
3.- Install light bulbs (not provided) that must not exceed markings on the fixture.
4.- To change the bulbs, disconnect the power by turning off the general switch and wait for the bulbs cool down.

INSTALLATION:
1.- Make electrical connections, carefully read the Electrical Connection section.
2.- Assemble lighting onto the outlet box as shown on fig. 6, & 7.

ELECTRICAL CONNECTIONS: (See fig. 3,4 y 5)
1.- Connect the white wire from the fixture to the white wire of the electric installation.
2.- Connect the black wire from the fixture to the black wire of the electric installation.
3.- Connect the grounding conductor from the fixture to the grounding wire of the electric installation.
4.- Spread out the electrical wires so that the black ones are on one side of the outlet box and the white ones are on the other side, and carefully introduce them into the outlet box.

ATTENTION:
1. Une mauvaise installation peut compromettre votre sécurité.
2. Déconnecter la tension du réseau d'alimentation avant de réaliser toute opération.
3. Installer les ampoules (non fournies), ne pas utiliser d'ampoules d'un autre type ou d'une puissance supérieure à celle indiquée sur l'étiquette de la lampe.
4. Pour changer les ampoules, déconnecter la tension du réseau d'alimentation et laisser refroidir les ampoules.

INSTALLATION:
1. Connecter au réseau, lire attentivement la section de "Raccordements électriques"
2. Installer l'appareil à la boîte de distribution comme indiqué dans les dessins 6 et 7.

RACCORDEMENTS ÉLECTRIQUES (dessins 3,4 et 5)
1. Connecter le câble blanc de l'appareil au câble blanc de l'installation électrique.
2. Connecter le câble noir de l'appareil au câble noir de l'installation électrique.
3. Connecter le câble conducteur de prise de terre au câble de prise de terre de l'installation électrique.
4. Distribuer les câbles pour que tout le câblage noir soit par dehors et le câblage blanc soit par dedans. Ajuster et immobiliser à la boîte sans coincer aucun câble.

1

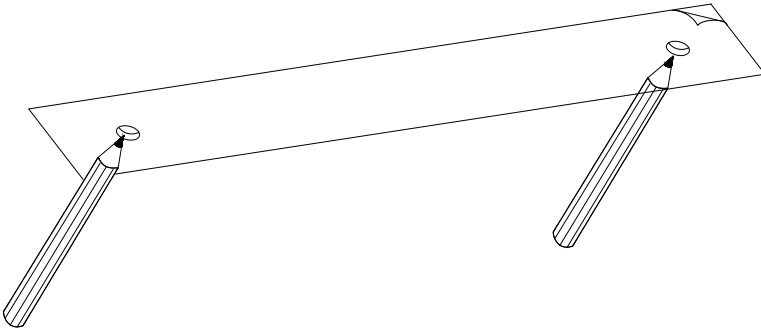

2

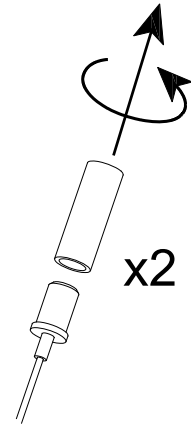

3

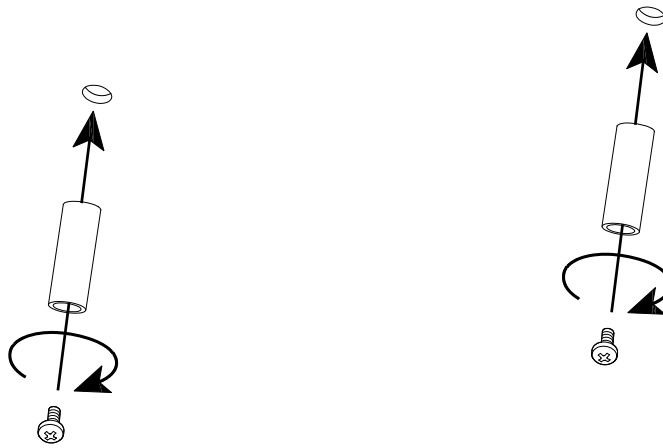

4

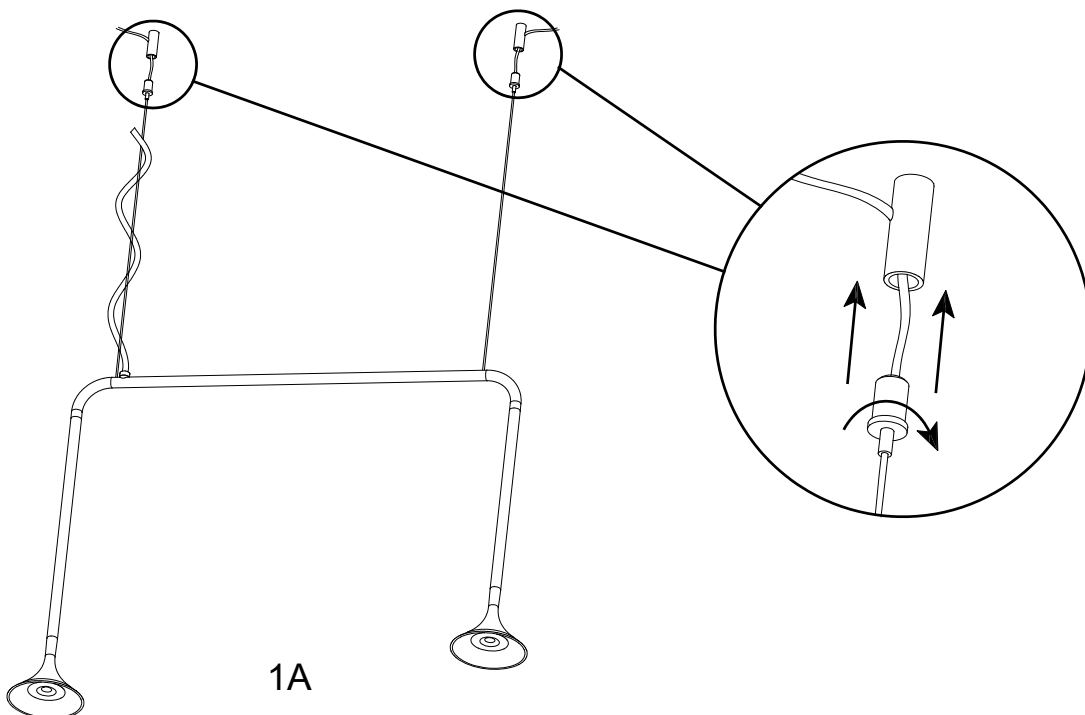

5

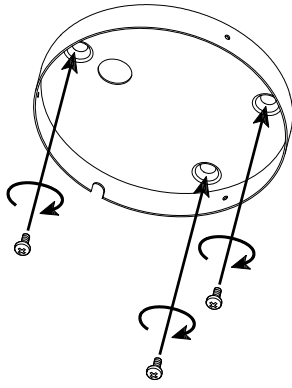

6

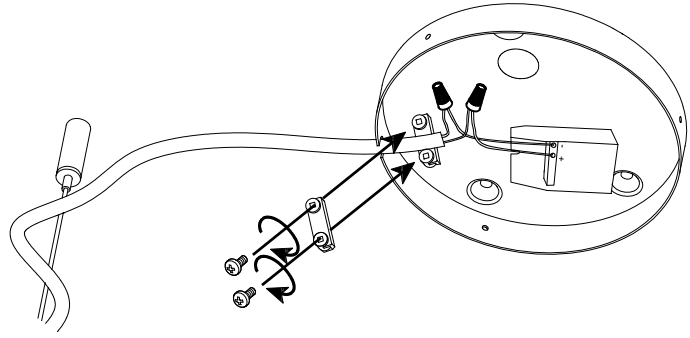

7

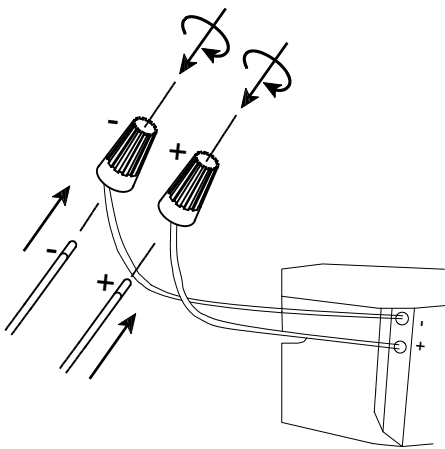

8

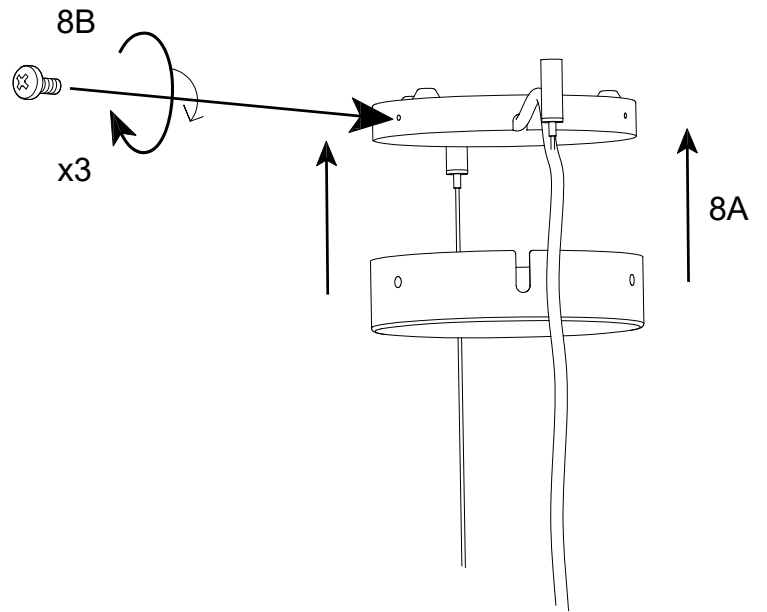

9

